

2024

BLUEPRINTS FOR HISTORY

FISCAL YEAR ANNUAL REPORT

JULY 1, 2023—JUNE 30, 2024



WISCONSIN
HISTORICAL
SOCIETY

DIRECTOR'S MESSAGE

Laying the foundation for the next 100 years of our history



Dear Friends,

As we wrap up the calendar year, it is my sincere privilege to present the Wisconsin Historical Society's fiscal year 2024 annual report. There is so much to celebrate this year, and even more to look forward to in the years ahead thanks to the generosity of friends like you.

While this report highlights the incredible accomplishments and impact from the past year, our theme—"Blueprints for History"—connects those achievements to the Society's plans for the next 100 years of collecting, preserving and sharing history. It also acknowledges the time, care and investment that is essential to design detailed blueprints and put them into action.

The impact of your support is evident on each page of this report and I hope you feel a strong sense of pride for everything you helped accomplish. I certainly reflect on the past fiscal year with overwhelming gratitude for the many individuals, organizations and government officials who champion the work of the Society and invest in our mission to connect people to the past.

Tremendous thanks are in order to the State of Wisconsin and private donors for fully funding the \$160.5 million design and construction budget of the new Wisconsin History Center. With this milestone behind us, our state will soon have a world-class facility to discover and share its history for generations to come. Our partners at the Wisconsin Historical Foundation continue to fundraise for the remainder of the project budget that includes exhibit fabrication, program development and pre-opening costs.

The history center will be a statewide resource for people in all Wisconsin communities and help us connect to one another, across time, through our shared history. Further, the plans laid for the history center are foundational for the investments being made across the agency that will benefit the entire state.

The History Makers Tour, which brings history directly to communities in all 72 Wisconsin counties, reached more than 55,600 people in fiscal year 2024 through pop-up exhibits and events setting the stage for the future of community engagement at the Society.

The AL. Ringling Theatre in Baraboo was donated to the Society to join Circus World's operations and benefit the entire Driftless Area with expanded history, arts and culture programming. This is one example of many projects across our historic sites and museums that boost the local economy and cultural offerings.

And that is just the beginning. With these plans and your generous support, we have the specifications, partnerships and investments in place for the next century of history in our state. Our blueprints use the past to inspire people to build a better future—together.

Please enjoy this report of our fiscal year 2024 impact. I hope you are as excited as I am about the future of collecting, preserving and sharing stories. I am looking forward to seeing these blueprints continue to come to life with friends like you by our side.

In Partnership,

A handwritten signature in black ink, reading "Christian W. Øverland". The signature is fluid and cursive, with a large, sweeping initial 'C'.

Christian W. Øverland
The Ruth and Hartley Barker Director & CEO
Wisconsin Historical Society

WISCONSIN HISTORICAL SOCIETY FY2024 FINANCIAL SNAPSHOT

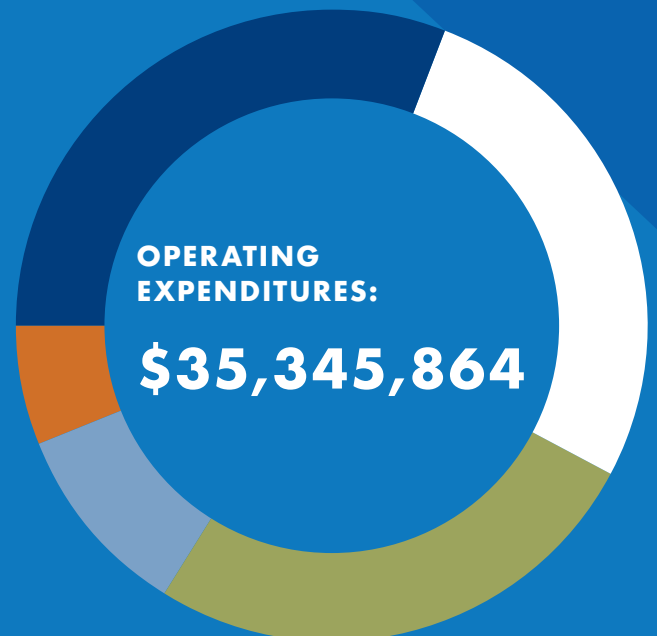
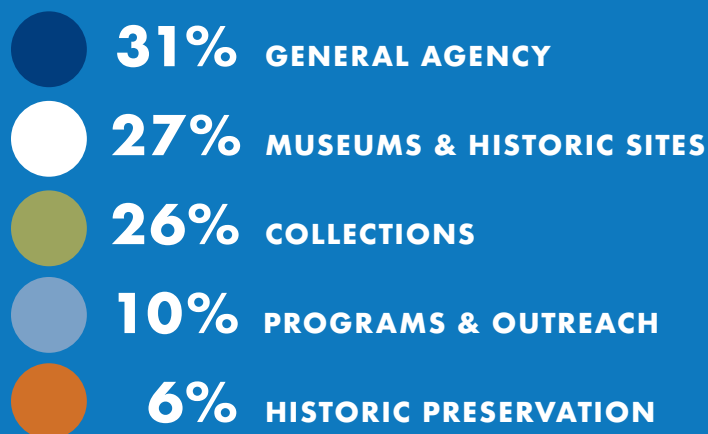
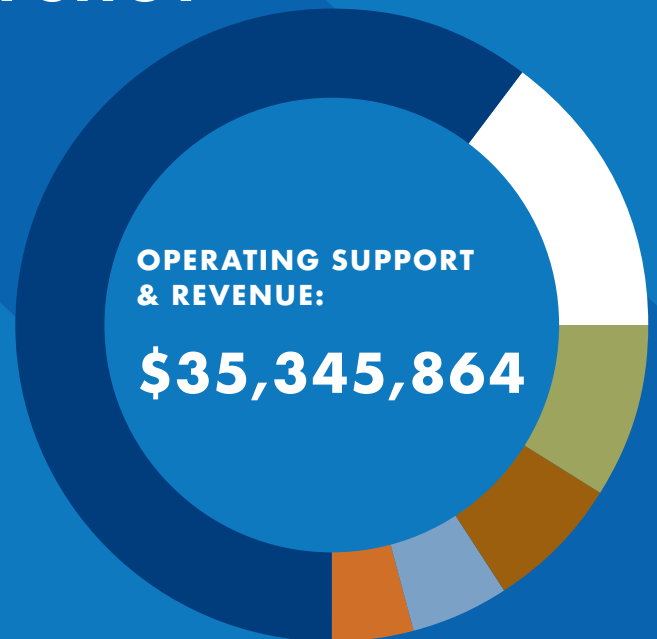
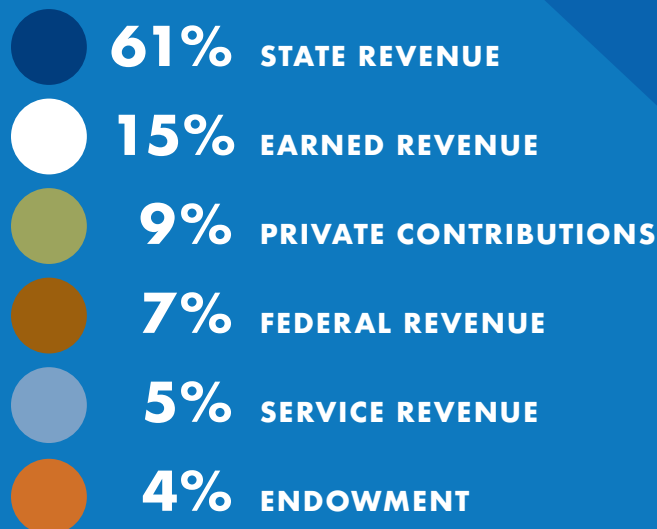

The Wisconsin Historical Society's ability to fulfill its mission of collecting, preserving and sharing stories is made possible by the consistent and unwavering support of the Wisconsin Legislature, the Governor's Office and administration, private donors, and members of the public that provide financial support through the use of Society services.

Note: Percentages may not equal 100 due to rounding. Totals do not include the Society's debt service appropriation.

WISCONSIN HISTORY CENTER UPDATE

KEY MILESTONES PROPEL FLAGSHIP HISTORY CENTER PROJECT FORWARD

Another year of significant milestones has rapidly advanced progress on the Wisconsin History Center project, bringing the vision of a transformative home for Wisconsin and North American history even closer. As the fiscal year concluded in June 2024, the project began its transition from drawing-board vision to shovels-in-the-ground reality, with site demolition set to begin in fall 2024. The new Wisconsin History Center remains on track for a 2027 opening.

The \$160.5 million design and construction budget has now been fully met, the State Building Commission unanimously granted the Society permission to construct the new history center, architectural design is complete, and planning for core galleries is well underway.





**The goal is to build a
history center worthy of our
state's stories and their national
impact—an inclusive, inspiring
space to provide unprecedented
access to the Society's
world-class collections.**

The State of Wisconsin awarded \$112.3 million for design and construction of the history center, contingent upon the Society securing an additional \$48.2 million in private contributions. That target was eclipsed when a \$10 million gift from philanthropist W. Jerome Frautschi vaulted private funding to \$53 million. Frautschi has now contributed more than \$25.1 million to the 100,000-square-foot future Wisconsin History Center on the state's Capitol Square. The Wisconsin Historical Foundation's total private fundraising goal of \$66.5 million will help fund design and construction, exhibit fabrication and additional expenditures required to open the facility.

The history center's design team, including exhibit designers Ralph Appelbaum Associates (RAA) and architectural firms Continuum Architects + Planners and SmithGroup, has collaborated to create a striking space inspired by Wisconsin's natural resources and rich history. The Madison Urban Design Commission and Madison Plan Commission approved those plans in late 2023 and the Society was given the go-ahead to begin construction by the State Building Commission shortly thereafter. The five-story building, with its angled exterior of weathered zinc, embossed steel, granite and bird-safe glass, will more than double the exhibition space of the former museum and serve as a cultural beacon for the entire state.

Planning continued through the year on the development of the history center's interior spaces, with the Society collaborating with RAA, community partners, a scholarly advisory panel and a Native Nations Council. Their work has focused on the history center's three core galleries. The

planning teams are tasked with defining each gallery's overarching narrative and themes and selecting the specific stories and artifacts to be displayed in each gallery to tell an immersive story of Wisconsin and North American history. The history center will also house a rotating community gallery sharing stories from across the state as well as a changing gallery large enough to house national traveling exhibits.

This work builds upon a strong foundation of community input, begun several years ago with the Share Your Voice tour that engaged more than 5,000 residents from throughout the state. The goal is to build a history center worthy of our state's stories and their national impact—an inclusive, inspiring space to provide unprecedented access to the Society's world-class collections. The Wisconsin History Center is expected to welcome more than 200,000 guests annually and double the number of school students served to 60,000.

BEHIND THE DESIGN

THE PEOPLE AND PLACES THAT ARE SHAPING THE NEW WISCONSIN HISTORY CENTER

The new home for the stories of the people of Wisconsin ought to feel like home to the people of Wisconsin. That's because the design of the new Wisconsin History Center will utilize materials which evoke and celebrate the state's natural resources and draw upon the wisdom of its people—incorporating lumber, stones, even wildflowers and other native plants from across the state.

The Wisconsin Historical Society has assembled a broad and diverse team charged with creating a fitting home for Wisconsin's history. Advice and input about the history center's design and materials come from several groups, each bringing their unique expertise and experiences.

Their input will be visible throughout the new history center, in its displays and its programming. Perhaps the most visible example of these partnerships will be a massive wooden staircase rising

across the lobby. This grand architectural element will be realized through a collaboration between the Society and Menominee Tribal Enterprises (MTE), a recommendation of the project's Native Nations Council. This advisory panel, which includes representatives from each of the Tribal nations in Wisconsin as well as other Indigenous cultural leaders, urged designers to incorporate real materials whenever possible.

Lumber for the grand staircase, designed to evoke the shape of dugout canoes, as well as for flooring throughout the center, will come from forests sustainably managed by MTE in the 230,000-acre Menominee Forest in Northern Wisconsin. A key partner in the history center project, MTE will also help collaborate on exhibits exploring MTE's history and the Menominee Forest.

"It's been over a year of planning and spending time with each other on the Menominee reservation learning, discussing and going out to the forest and the mill to be able to put together not only a better project, but to tell a story that is very unique, that we all have a part in telling," said Nels B. Huse, marketing specialist with MTE. "The detail of the monumental staircase, the end grain flooring, and furniture required us to have this partnership that only this team can do together."

Visitors will be delighted by other nods to the state's natural resources throughout the history center's design. Guests may find stones from Wisconsin's shorelines surrounding structural pillars in the building or imprints of native plants surrounding the elevators. Some spaces include design elements to evoke the feeling of being in a Wisconsin prairie with wildflowers in bloom while others include inspiration from rich basket weaving traditions.

"Every element of the building's design is being carefully considered to provide visitors with a deep sense of place among Wisconsin's varied landscapes," said deputy director and chief operating officer Wes Mosman Block. "With every decision, we are taking seriously our responsibility to create a truly 'Wisconsin' History Center."

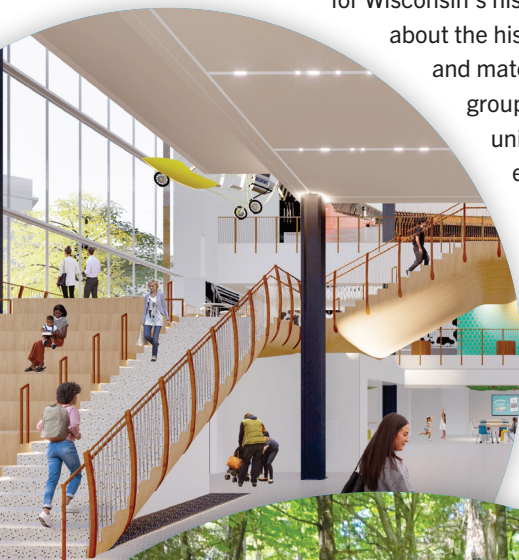



WHAT DOES IT TAKE TO DESIGN A HISTORY CENTER?

The Society and its partners have been hard at work designing the three core galleries and two changing galleries that will be featured in the new Wisconsin History Center—but what does it take to create immersive exhibitions that feature stories and collections of national significance that represent people and places across the entire state?

In fiscal year 2024, the Society established internal design teams for each gallery to bring initial themes and concepts to life. Gallery design will continue into 2025 with fabrication starting in 2026. Here is what our design team has been up to this year!

2 DESIGN PHASES

1 Schematic Design

Preliminary content, storyline and theme development for exhibitions and initial artifact identification.

2 Design Development

Refine specific stories and topics for each exhibition as well as artifact and image selection.

40+

Society and
Foundation staff

2,500+

Staff hours

636

People engaged

30

Workshops with
renowned
exhibit design firm
Ralph Appelbaum
Associates

1,240

Artifacts digitally
rendered by
Ralph Appelbaum
Associates for
design review

100+

Pairs of gloves worn
to handle collections
during research

1,500+ Artifacts and archival collections researched



No small feat

“It is truly an incredible amount of very thoughtful work our team is doing to prepare for these galleries,” said Nick Hoffman, the Society’s administrator of museums & historic sites. “Each artifact, archival collection and story is carefully researched, discussed and considered from every angle to determine how best to share our state’s story. It is no small feat—and we are grateful to have the engagement of community councils and advisory committees to help create exhibitions that represent all of Wisconsin and our evolving impact regionally and nationally throughout history.”

A DEEP DIVE INTO COLLECTIONS RESEARCH

RESEARCH FOR HISTORY CENTER UNCOVERS STORIES ABOUT COLLECTIONS

The Society is drawing upon its world-class collection of nearly 290 million items to create exhibitions in the new history center that will leave visitors curious and inspired by our state's history. Over the past year, the Society has identified and studied thousands of items to inform storytelling in the history center—but sometimes they must dig a little deeper.

“Our team has been on a glorious treasure hunt to research the stories behind our collections,” said collections director Jill Sterrett. “We have uncovered new findings and stories about our collections that will enhance storytelling and delight future visitors to the history center.”

20-STAR CIVIL WAR LOYALTY FLAG

A 20-star Civil War Loyalty Flag is one exceptional object that required further investigation. The flag was donated to the Society in 1896 by Horace Beach, a Prairie du Chien businessowner and president of the local Union League. During the Civil War, Union Leagues formed across the North to promote loyalty to the Union.

Why would a Union League in Prairie du Chien use a 20-star flag to represent their club when the official United States flag at the time sported 34 stars? What was the flag's origin and how could it best be displayed in its fragile state? That's what a group of experts set out to uncover during a two-day study session supported by a grant from Americana Corner in October 2023.

The collaborative research panel included experts from the Smithsonian National Museum of American History, UW-Madison School of Human Ecology's textiles program, Midwest Art Conservation Center and cross-disciplinary Society experts.

“The Society assembled an impressive level of expertise to exchange ideas on the range of possibilities involved in the conservation, location and interpretation of the Prairie du Chien Loyalty Flag,” said Marilyn Zoidis, senior curator emerita of the Star-Spangled Banner Preservation Project at the Smithsonian National Museum of American History. “Because historic flags carry complex issues that evoke personal meanings, everyone recognized the challenges. The Society welcomed and embraced multiple viewpoints and made us all feel that we had a stake in the outcome—a model for any such undertaking.”

Through lively discussion, the group gained a better understanding of the historical and geographical context during the flag's use, including that it was homemade in accordance with government specifications at the time. While the exact significance remains a mystery, the team identified new leads to continue this research. All participants in the prestigious group of experts acknowledged that this interdisciplinary approach is unique in the field of collections research and set a new precedent for research possibilities at the Society and beyond.





“WE HAVE A LOT TO LEARN FROM THE MENDOTA CANOE SITE, AND THE RESEARCH HAPPENING TODAY ALLOWS US TO BETTER UNDERSTAND AND SHARE THE STORIES OF THE PEOPLE WHO LIVED HERE AND HAD A THRIVING CULTURE HERE SINCE TIME IMMEMORIAL.”

Larry Plucinski, Tribal Historic Preservation Officer for Bad River Band of Lake Superior Chippewa

MENDOTA DUGOUT CANOES

Collaborative research over the past year with Native Nations in Wisconsin revealed new details about the Mendota Dugout Canoes and the archaeological site where they were discovered. These findings will support sharing the history of Indigenous peoples who have called the land now known as Wisconsin home for thousands of years—both in the history center and beyond.

Two submerged canoes, approximately 1,200 and 3,000 years old, were previously identified and recovered from the site in 2021 and 2022, respectively. Researchers identified at least eight additional submerged canoes offering more evidence to enhance the histories shared at the history center and beyond. The news of the additional findings and expanded significance of the archaeology site reached a world-wide audience in the summer of 2024.

“We have a lot to learn from the Mendota canoe site, and the research happening today allows us to better understand and share the stories of the people who lived here and had a thriving culture here since time immemorial,” said Bad River Band of Lake Superior Chippewa Tribal Historic Preservation Officer Larry Plucinski, who participated in the recovery and research.

Archaeologists hypothesize that the canoes may have been intentionally cached in the water to prevent freezing and warping in the winter months and were later buried by natural forces over time. Radiocarbon dating results indicated the oldest canoe in the cache is approximately 4,500 years old—making it the oldest dugout canoe now recorded in the Great Lakes Region.

The Society will not attempt to recover additional canoes from the site due to their fragile condition. The decision was made in collaboration with Tribal historic preservation officers.

While research continues at the site, the two recovered canoes are undergoing a preservation process that uses Polyethylene Glycol (PEG) to stabilize the wood and takes several years. Once complete, the canoes will be transported to Texas A&M University to undergo a freeze-drying process that leaves the canoes in a stable, solid structure suitable for public display.



MORE INFORMATION

Learn more about this discovery and ongoing research at wihist.org/canoe



HISTORY MAKER SPACE

TEMPORARY PROGRAMMING SPACE SERVES THOUSANDS OF WISCONSIN RESIDENTS

It may be a temporary home for history-related activities until the opening of the new Wisconsin History Center, but the History Maker Space made some history of its own this past year.

The space, located on the first floor of the US Bank Plaza on Capitol Square, welcomed thousands of visitors in its first full year of operation to provide continued educational services and public programming while the Wisconsin History Center is under construction. Visitors enjoyed a full calendar of events, camps and special activities in the space, which also includes a retail store focused on Wisconsin-inspired products and makers, and an interactive education hub for school groups.

The History Maker Space hosted more than 7,600 students, teachers and chaperones from communities across Wisconsin. Educators and students lauded the programs offered in the space and praised their focus on building critical thinking skills and providing hands-on, experiential learning opportunities.

"These hands-on activities encourage students to see the relevance of history in their lives today, fostering a connection between their learning and the world around them," said Carol Patterson, fourth grade teacher in the Sauk Prairie School District, who brought her students to the History Maker Space

in May. "By actively participating in historical reenactments or crafting items from a particular era, they gain a richer, more personal appreciation of the people, cultures and events that have shaped our world. This direct interaction with historical artifacts and processes makes history exciting and memorable, and it often ignites a lifelong interest in the subject."

Other offerings attracted a broad audience. In April, approximately 150 people attended a Polka Party in the History Maker Space, which commemorated the 30th anniversary of polka's designation as the official state dance. People of all ages filled the spaces with music and dance, enjoying tunes from a polka band and DJ. Food and beverages complemented the theme and digital displays presented a fascinating glimpse of polka and dance hall history in the state. In June, the Society hosted the Madison Black History Walking Tour, which highlighted the city's Black community from the 1860s to the early 1900s.

The retail store found success by prioritizing local vendors, makers and authors to showcase locally made products and stories—generating nearly \$40,000 in sales to support the Society's operations. The History Maker Space is made possible by generous support from J.H. Findorff & Son and Urban Land Interests.



MORE INFORMATION

Learn about upcoming History Maker Space events and programs at wihist.org/historymakerspace



HISTORY MAKERS TOUR

SOCIETY KICKS OFF 3-YEAR STATEWIDE ENGAGEMENT TOUR

A collaborative effort designed to bring history directly to communities throughout the state saw more than 30 events and 55,607 visitors over the course of its first year. The Wisconsin History Makers Tour, an innovative program allowing the Society to continue serving communities statewide while the new Wisconsin History Center is under construction, launched in September 2023, traveling first to the south central and southeastern parts of Wisconsin.

The tour features pop-up exhibits, artifact displays, interactive historic image installations, author talks and other special events. Many tour stops are coordinated with local or regional partners, such as libraries, history organizations and cultural venues. The tour was made possible through the generous support of Culver's and a grant from the Institute of Museum and Library Sciences (Grant Number: MA-253159-OMS-23).

A key feature of the tour is the collaboration with community partners, which helps increase engagement and allows for more meaningful events. One traveling environmental exhibit on the Great Lakes and water's role in shaping Wisconsin was seen by thousands of viewers at public libraries in Germantown, Mount Horeb and Beaver Dam. Beaver Dam Public Library coordinated the exhibit to coincide with the library's annual Science Festival, attended by more than 600 people.

Another traveling display highlighting the women's suffrage movement in Wisconsin, "We Stand on their Shoulders," was hosted by numerous historical museums and public libraries and illustrates the ways local organizations can help shape the event. In Columbus, the public library organized and ran voter registration events concurrent with the exhibit and estimated nearly 2,000 attendees. Meanwhile, the Sun Prairie Historical Library and Museum added material from its own archives to make the experience even more relevant for visitors.

The History Makers Tour also features brand-new customizable exhibits that allow compelling historical artifacts to travel across the state, invite the public to "step into history" by posing in life-sized historical images and learn more about Wisconsin culture through outdoor "history walk" pop-up exhibits.

The tour will visit other areas of the state over the next few years, leading up to the opening of the new Wisconsin History Center in 2027.



INSTITUTE of
Museum and Library
SERVICES



MORE INFORMATION

Check out where the History Makers Tour will be next at wihist.org/historymakerstour



NEW ERA OF VISITOR EXPERIENCES

HISTORIC SITES EXPAND STORYTELLING, EVENTS AND EXPERIENCES

Across the state, growing attendance at the Society's 12 historic sites and museums over the past two summers served as a testament to the success of efforts to provide more engaging and immersive visitor experiences. From an in-depth exploration of the Ojibwe peoples' long presence on the Apostle Islands, to new events at Black Point Estate & Gardens, to flashback field trips for adults at Old World Wisconsin, the new interactive experiences are attracting increasing numbers of visitors, young and old.

"It's an exciting time at the historic sites and museums," said Nick Hoffman, administrator of the division of museums & historic sites for the Society. "We're testing new ways for visitors to experience history, strengthening collaboration both across the Society and with communities, and expanding the power of layered history at our sites to tell more dynamic stories."

Our innovative experience development process produced the compelling and significant new exhibition on "Passages: Ojibwe Migration to the Place Where Food Grows on the Water." With design led by Madeline Island Museum's new director, Michael Wiggins Jr., former Tribal chairman and executive director of the Bad River Band of Lake Superior Chippewa, the exhibit explores the history of the Apostle Islands through the stories of the Ojibwe people who have long called the area home.

"Stories passed on through generations recount our 500-year journey from the east coast to this powerful region where food grows on water," said Wiggins. "Much of our ancestors' travel was prophesied, and this exhibit offers a rare look into our culture, from establishing a home here to the efforts of Chief Buffalo to secure our land for the future."

The Society's other sites hosted numerous special events throughout the year, many centered around historic holiday traditions, arts and trades, or Wisconsin-inspired food and drink. Visitors found themselves playing era-appropriate games, dining on locally sourced, seasonal feasts, riding in horse-drawn carriages, crafting tools, and partaking in numerous time-honored activities carefully designed to bring history to life.



**HISTORIC SITES AND
MUSEUMS WELCOMED
220,930 GUESTS
IN FISCAL YEAR 2024**

A new era

At **WADE HOUSE**, visitors forged their own knives in the blacksmith's shop and sipped their way through a mixology lesson at two of the more than two dozen special events scheduled for the 2024 calendar year.

At Old World Wisconsin, the Halloween-themed **LEGENDS & LORE** enlisted students from the Kettle Moraine School for Arts and Performance to bring eerie tales to life. Ticket sales nearly doubled from the previous year.

Old World's **HOME FOR THE HOLIDAYS** celebration stretched over three weekends and invited visitors to join in festive activities sure to spark holiday cheer. Attendees made crafts, sipped on cider as they listened to fireside stories and got in some last-minute holiday shopping in the Crossroads Christmas Shoppe. Attendance was up considerably over the previous year, a trend noticed across the state.

"History never gets old! There are more stories we're excited to tell and new history-inspired experiences we can't wait to share at our historic sites and museums across the state," said Hoffman.



MEMBER PASTPORT

The 2023 site season was the first with our Member PastPort—encouraging members to travel to all historic sites and museums to get their PastPort stamped and win special prizes. We handed out 1,778 PastPorts in 2023 and heard from 66 members who received stamps from nine sites in one season. The Member PastPort returned for the 2024 site season.

● **9,581**
BLACK POINT
ESTATE & GARDENS

● **17,408**
H.H. BENNETT
STUDIO & MUSEUM

● **74,115**
OLD WORLD
WISCONSIN

● **7,610**
STONEFIELD

● **62,204**
CIRCUS WORLD

● **9,430**
HISTORY MAKER SPACE

● **2,739**
PENDARVIS

● **11,246**
VILLA LOUIS

● **959**
FIRST CAPITOL

● **14,202**
MADELINE ISLAND
MUSEUM

● **383**
REED SCHOOL

● **11,053**
WADE HOUSE

HISTORIC INVESTMENTS AT HISTORIC SITES

BUILDING IMMERSIVE EXPERIENCES ACROSS THE STATE

The Society's plans for its 12 historic sites and museums across the state include significant investments in infrastructure to expand programming. In addition to completing 30 capital projects totaling \$4 million at locations across the state, the following major projects highlight how these investments will support greater cultural and economic impact in Wisconsin communities.

"Our historic sites and museums are deeply embedded in their local communities," said Angela Titus, the Society's assistant deputy director & chief program officer. "We are excited to make strategic investments in all areas of the state to serve the public and to provide Wisconsinites unprecedented access to their history and historic places."

CIRCUS WORLD ADDS HISTORIC AL. RINGLING THEATRE

In March 2024, the historic AL. Ringling Theatre was donated to the Society to join Circus World's operations, a move that ensures the long-term future of the beloved regional theatre. The donation was made possible by working with the AL. Ringling Theatre Friends, Inc., to secure \$3.07 million in private gifts from community donors.

Designed in the opulent style of grand French opera houses, the 700-seat theatre was built in 1915 by Al Ringling, co-founder of the world-renowned Ringling Bros. Circus. The theatre, which was listed on the National Register of Historic Places in 1976, has hosted national touring companies, vaudeville, motion pictures and more, bringing performing arts and culture to Baraboo and the region.

"Operating the AL. with the rest of the Society's historic sites is a natural tie to our mission of connecting people to history by sharing stories and serving communities throughout our great state," said Christian Øverland, the Ruth and Hartley Barker Director & CEO. "We are grateful for the incredible support from the people of Baraboo—a place that is rich with history and a community where the Society has strong roots already with Circus World."

As the Society works toward its master plan at Circus World, the acquisition underscores its commitment to the Baraboo community and surrounding Driftless region. The theatre will be an extension of Circus World, turning it into a year-round, multi-venue attraction. In addition to big top shows and exhibitions on the Circus World grounds, the nearby theatre will host regional performing arts programming, community programs and private events.

"This is the outcome that we wanted to see to secure the long-term future of the AL.—it's a win for Baraboo, a win for the regional arts community and a win for historic preservation in Wisconsin," said Paul Wolter, Vice President of the AL. Ringling Theatre Friends, Inc. "The theatre will now benefit from the Society's resources, operating infrastructure and expertise."

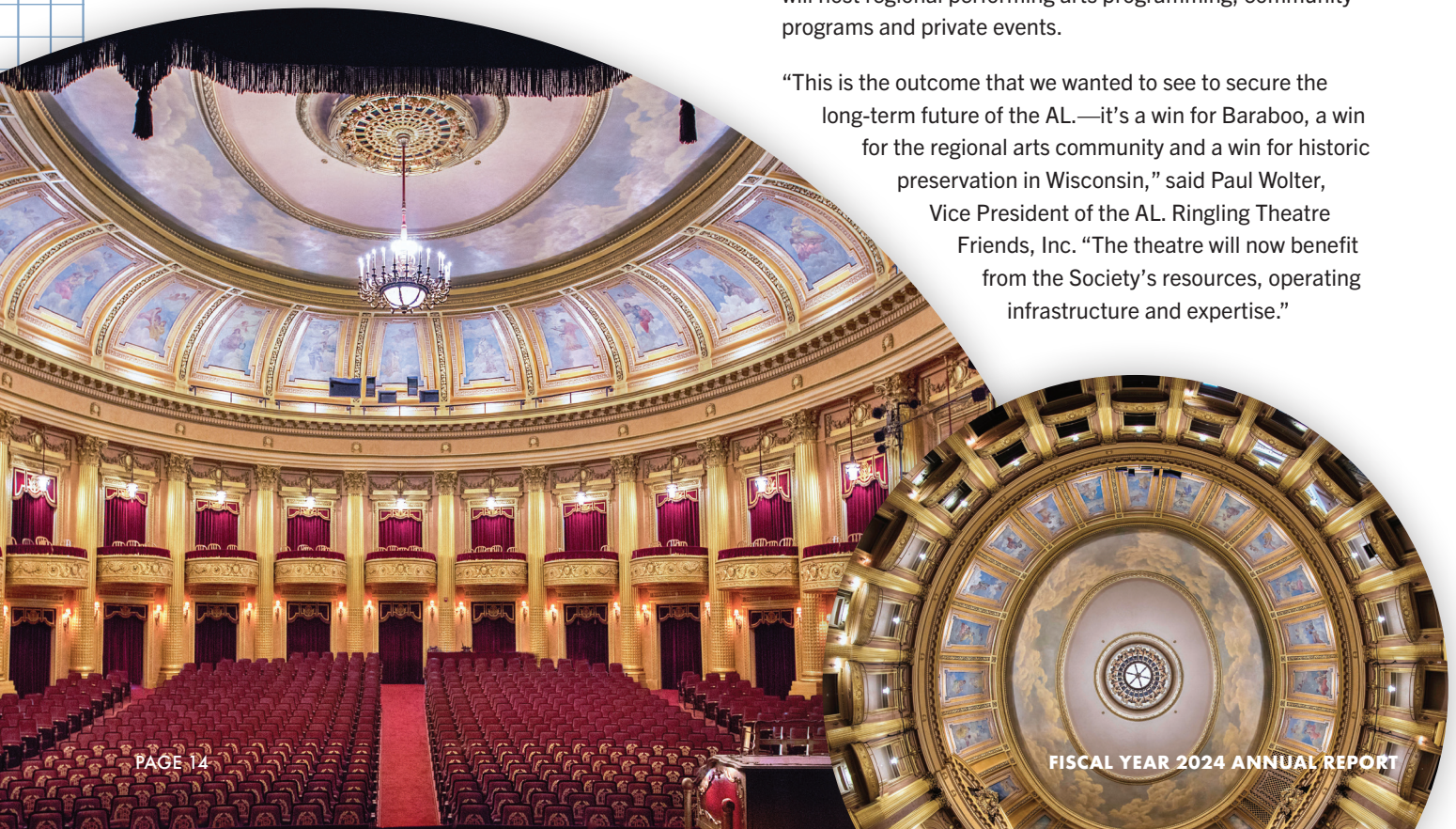

**"IT'S A WIN FOR BARABOO,
A WIN FOR THE REGIONAL
ARTS COMMUNITY AND
A WIN FOR HISTORIC
PRESERVATION IN
WISCONSIN."**

*Paul Wolter, Vice President,
AL. Ringling Theatre
Friends, Inc.*



Photography by Bill Johnsen

NEW HORSE ARENA OPENS AT WADE HOUSE

During the past year, a beautiful new horse arena was completed at Wade House, the historic site in Greenbush where guests immerse themselves in the horse-powered world of the 1800s.

The new arena, funded by a generous gift from the Kohler Trust for Preservation and dedicated in memory of Herbert Kohler, Jr., ushers in a new era of equine events at the site and elevates its annual Carriage Driving Days event. The event celebrates the sport's beauty and pageantry, with elegantly attired drivers, skillfully maneuvering their horse-drawn carriages through a series of competitions. In July 2023, the inaugural event in the new arena broke attendance records with 440 tickets sold, attracting media, tourism and visitors to Sheboygan County.



NEW TO THE SOCIETY'S COLLECTIONS

A FOCUS ON COLLECTING FOR THE NEW WISCONSIN HISTORY CENTER

As the Wisconsin Historical Society prepares to open a flagship history center that shares the story of Wisconsin and beyond, our team has been actively identifying and acquiring compelling new collections that represent the people, places and innovations that have shaped our state and impacted the nation. "In partnership with advisory groups and community councils, our team has been collecting items that fill gaps in our collections, acquiring some incredibly iconic artifacts and growing our collections to include unexpected or previously untold stories," said Jill Sterrett, director of collections. "We are grateful to steward these items as part of our collections and excited to make them accessible to people across the state through the new Wisconsin History Center."



OLD STYLE NEON SIGN

Beer production helped put La Crosse on the national map thanks to G. Heileman Brewing Co., which was founded in 1858 (as The City Brewery) and eventually brought its signature Old Style lager to the national market. This iconic neon sign from the Old Style Country Stage stood high above the crowds at Milwaukee's Summerfest from about 1983 through 1996. Once restored, it will be prominently displayed in a staircase that will connect the third and fourth floors of the Wisconsin History Center and feature historic neon signs from across the state. The collection donation from Sandy Cleary, a descendent of the Heileman family, helped launch the collection project to highlight unique neon signs in the new history center. *Promised gift of Sandy Cleary.*



RACING SAUSAGES

The original three Milwaukee Brewers "Racing Sausages"—Bratwurst, Polish and Italian—which debuted on the field in 1993, joined the Society's collection. Based on a scoreboard animation, Michael Dillon—graphic designer and family friend of a team executive—pitched the idea of a real race and fabricated the 7-foot-tall foam costumes in his garage. Today, two-thirds of all MLB teams have adopted similar characters to entertain their fans. *Purchased by the Wisconsin Historical Society.*

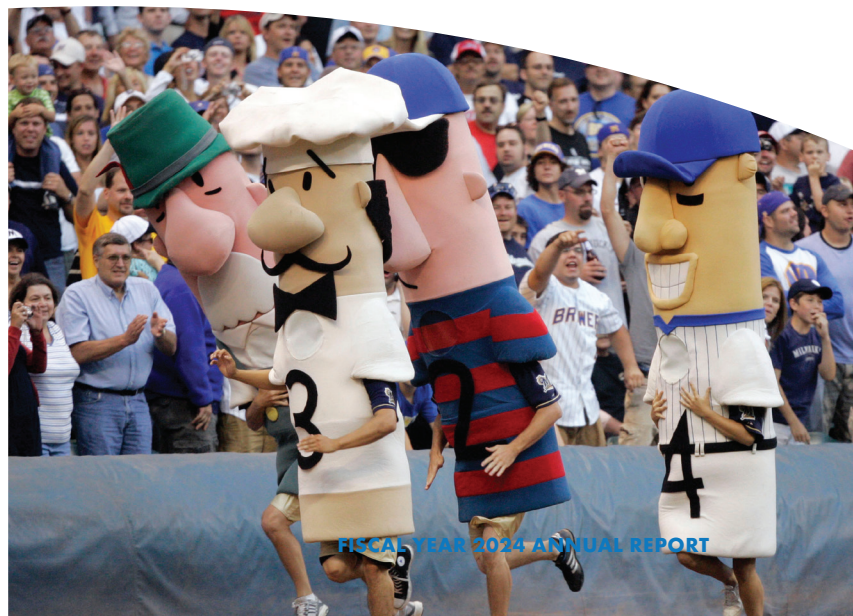



CHARRO OUTFIT

Javier Sánchez Macías came to Wisconsin in 1966 to work on a dairy farm near Elkhorn. Prior to that he was a Charro, competing in Charrería (Mexican horsemanship). The Society has acquired several items worn and used during these competitions through a partnership with the Wisconsin Latinx History Collective.



Javier wearing the Charro garments from the papers of the Sánchez family, including photographs, correspondence, immigration documentation and related ephemeral materials, circa 1930-1970.



DUNGEONS & DRAGONS

The year 2024 marks the 50th anniversary of the creation of Dungeons & Dragons. This influential role-playing game was created in Lake Geneva, Wisconsin in 1974 and went on to become a world-wide phenomenon. The Society acquired a 1979 Basic Dungeons & Dragons box set as part of a collecting plan for the Wisconsin History Center that highlights the social and emotional impact Dungeons & Dragons has made around the world. *Donated by Ben Klepzig.*



DAVID MARANISS PAPERS

The Society acquired papers of veteran journalist and New York Times best-selling author, David Maraniss, a Madison native who won two Pulitzer Prizes and wrote 13 nonfiction books. His notable books include, "They Marched into Sunlight," about UW-Madison student protests against the Vietnam War and, "When Pride Still Mattered," a biography of Vince Lombardi. The papers include his story research, drafts, correspondence, publicity, photographs and other materials.

STATEWIDE IMPACT OF YOUR STATE HISTORICAL SOCIETY

WHERE HAS THE WISCONSIN HISTORICAL SOCIETY BEEN IN FISCAL YEAR 2024? SEE JUST SOME OF THE WAYS OUR WORK REACHES ALL 72 WISCONSIN COUNTIES!

LEGEND



ARCHAEOLOGICAL FIELD WORK PROJECTS (121)

The State Historic Preservation Office and Society's Museum Archaeology Program (MAP) conducts archaeological field work and research across the state every year.



SCHOOLS ADOPTING FOURTH-GRADE WISCONSIN HISTORY TEXTBOOK (385)

The Society's elementary history textbook "Wisconsin: Our State, Our Story" encourages critical thinking and invites students to become eyewitnesses to the past.



AREA RESEARCH CENTERS (14)

The network of Area Research Centers provides access to local records and manuscript collections. Patrons can also request collections from across the state to be sent to their local ARC.



SCHOOLS PARTICIPATING IN NATIONAL HISTORY DAY (81)

NHD is more than a day; it is an opportunity for students to think beyond the textbook by researching and creating their own project based on a historical topic that interests them.



LOCAL HISTORY AFFILIATES (438)

The Society provides resources for local history organizations, including an annual conference, webinars, workshops, grants and information to start local history organizations.



SCHOOLS VISITING HISTORIC SITES & MUSEUMS (451)

Students across the state visit our historic sites and museums for sensory-rich, wonder-filled field trips that align with state educational standards while incorporating creativity, critical thinking and storytelling.



HISTORIC SITES & MUSEUMS (12)

In fiscal year 2024, the Society's historic sites and museums welcomed 220,930 visitors to 12 locations across the state!



SOCIETY PRESS AUTHOR TALKS & BOOK EVENTS (170)

The Wisconsin Historical Society Press hosts author talks and book events all across the state, letting you connect with your favorite Wisconsin history authors!



NATIONAL REGISTER OF HISTORIC PLACES LISTINGS, NEW IN FY2024 (30)

Wisconsin is home to approximately 2,400 listings in the National Register of Historic Places, the nation's official list of historic places worthy of preservation.

Making an impact



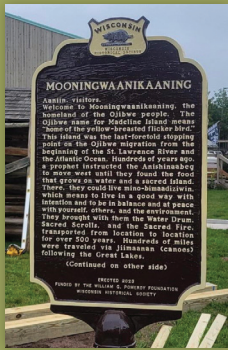

MOONINGWANEKAANING

A new historical marker, Mooningwanekaaning, was dedicated in September 2023 and replaced a 1961 marker inaccurately stating that the island was discovered by the French. The new historical marker, which bears the Ojibwe name for Madeline Island and was developed using input from the Bad River and Red Cliff Ojibwe communities, recognizes the central role of Ojibwe peoples in the island's history.



SURVIVAL FOOD

Published by the Society Press in fiscal year 2024, "Survival Food: North Woods Stories by a Menominee Cook" shares author Thomas Pecore Weso's stories of growing up on the Menominee

Indian Reservation and the important role that food and foodways played in his community. The book was selected as the Wisconsin entry in the "Great Reads from Great Places" program at the Library of Congress's National Book Festival, among other awards and accolades.



LOCAL HISTORY & HISTORIC PRESERVATION CONFERENCE

The 2023 Local History & Historic Preservation Conference welcomed 242 attendees, representing 49 Wisconsin counties and three states, in La Crosse to learn under the theme of "Centering Community: Exploring the Intersection of Community, Identity and History."

WISCONSIN HISTORICAL SOCIETY 2024 FISCAL YEAR BY THE NUMBERS



HISTORIC SITES & MUSEUMS

● **220,930** total attendance at historic sites and museums

● **30** capital projects completed across the state

● **44,227** K-12 attendance at historic sites and museums

● **9,430** people served at History Maker Space





LIBRARY, ARCHIVES & MUSEUM COLLECTIONS

● **193,366** patrons served by the Society's library & archives

● **244** objects acquired for collections

● **92** archival collections acquired

● **279,291** collection items digitized

● **166** local governments served via in-person consultations

● **1,500+** artifacts & archival collections researched for the new Wisconsin History Center

PROJECT SPOTLIGHT

Thanks to a \$750,000 Save America's Treasures grant administered by the Institute of Museum and Library Services, the Society can preserve and digitize 26 critical collections documenting those at the forefront of the American Civil Rights movement.

Grant Number: MA-253159-OMS-23



By the numbers



HISTORIC PRESERVATION

- **22,140,021** dollars approved in federal historic preservation tax credits
- **225,348,431** dollars invested in rehabilitated historic properties
- **3,922** projected jobs created by rehabilitation projects
- **255** buildings rehabilitated using tax credit programs
- **58** buildings added to the National Register of Historic Places
- **30** individual properties listed in the National Register of Historic Places

OUTREACH

- **242** attendees at 2023 Local History & Historic Preservation Conference
- **551** consultations with local history affiliates
- **55,607** people reached through the History Makers Tour
- **32** pop-up events or displays as part of the History Makers Tour
- **13** new Wisconsin State Historical Markers installed

PROJECT SPOTLIGHT

The Ojibwe Winter Storytelling Series, which featured four Ojibwe speakers over four weeks in January 2024, reached more than 6,000 viewers.



PRESS

- **7** books published by the Society Press
- **44,940** books sold by the Society Press
- **170** in-person author talks and book events
- **41,390** copies of the Wisconsin Magazine of History delivered to Society members

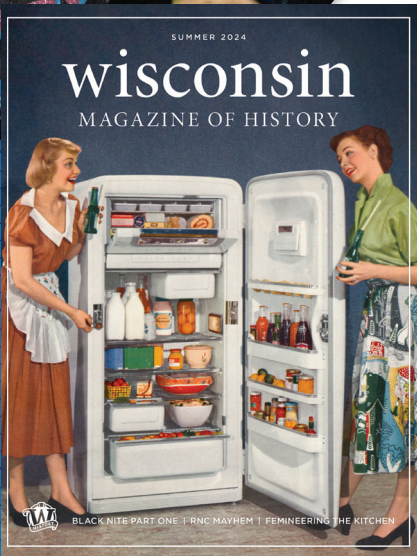

PROJECT SPOTLIGHT

The Wisconsin Magazine of History completed a major redesign, introducing a more visual and accessible layout that features both longform scholarly articles and bite-size, digestible pieces of history.

EDUCATION

- **6,000** Wisconsin students participated in National History Day (NHD) program from 81 schools
- **56,814** students used the Society's elementary Wisconsin history textbook
- **58** students qualified for NHD national competition in Maryland
- **5,972** students served at History Maker Space from 122 schools
- **4** students finished in the top 10 or won special awards at NHD nationals
- **451** schools visited historic sites & museums for a field trip or educational program

SINCERE THANKS TO OUR LEADERSHIP TEAMS

We gratefully recognize the members of the Wisconsin Historical Society Board of Curators, Wisconsin Historical Foundation Board of Directors and Wisconsin Historical Real Estate Foundation Board who served from July 1, 2023, through June 30, 2024. Your leadership and direction helped achieve amazing results and set the plans and blueprints for the future of history. Thank you for your extraordinary service!

WISCONSIN HISTORICAL SOCIETY BOARD OF CURATORS

OFFICERS

Angela Bartell, Madison – President
Donald Schott, Madison – President-Elect
Greg Huber, Wausau – Past President
Jeffrey Cheney, Sheboygan – Treasurer
Christian W. Øverland, Fitchburg –
Secretary

TERM MEMBERS

Marcia Anderson, Verona
Tom Boldt, Appleton
Eric Borgerding, Verona
Mary Buestrin, Mequon
Jeff Buhrandt, Madison
Ramona Gonzalez, La Crosse
Mary Jane Herber, De Pere
Joanne Huelsman, Waukesha
JP Leary, Green Bay
John Mann, Eau Claire
Janan Najeeb, Mequon
Lowell Peterson, Appleton
Julie Ragland, Milwaukee
Thomas Shriner, Shorewood
Robert Smith, Glendale
Leonard Sobczak, Milwaukee
Jeff Swalve, Waunakee
John Thompson, Madison
Terri Yoho, Adell
Aharon W. Zorea, Richland Center

GOVERNOR'S APPOINTEES

Beth Meyers, Bayfield
Sondy Pope, Mount Horeb
Keene Winters, Wausau
Cate Zeuske, Green Bay

LEGISLATIVE APPOINTEES

Rep. Jill Billings, La Crosse
Sen. LaTonya Johnson, Milwaukee
Rep. William Penterman, Columbus
Sen. Van Wanggaard, Racine

CURATORS EX-OFFICIO

Cody Schreck, Sturgeon Bay, President,
Wisconsin Council for Local History
Laura Cramer, Kenosha, President,
FRIENDS of the Wisconsin
Historical Society
Patrick P. Fee, Wauwatosa, Chair,
Wisconsin Historical Foundation
Board of Directors

WISCONSIN HISTORICAL FOUNDATION BOARD OF DIRECTORS

OFFICERS

Patrick P. Fee, Wauwatosa – Chair
Gary Pesicka, Eau Claire –
Vice Chair & Treasurer
Cathi Wiebrecht-Searer,
Madison – Secretary

BOARD OF DIRECTORS

Jason Adamany, Fitchburg
Sandy L. Anderson, Merrimac
Karla M. Ashenhurst, Brookfield
Joan Bachleitner, Madison
Kathleen Burke, Hartland
Sandy Cleary, La Crosse
Paul Covalleski, Middleton
Susan Crane, Burlington
Diane Dei Rossi, Rhinelander
Jay Ellingson, La Crosse
Conrad G. Goodkind, Whitefish Bay
Reed E. Hall, Madison
Jerry Janiszewski, Greenfield
Joshua Jeffers, Milwaukee
Daniel M. Pfeiffer, Sussex
Karl Robe, Mukwonago
Andrea Ruiz, Madison

Dr. David S. Ryder, Mequon
Danny S. Tang, Milwaukee
Jane Villa, Madison

DIRECTORS EX-OFFICIO

Angela Bartell, Madison, President,
Wisconsin Historical Society
Board of Curators
Jonathan Beck, Madison, President,
Wisconsin Historical Real Estate
Foundation
Donald K. Schott, Madison,
President-Elect, Wisconsin Historical
Society Board of Curators

DIRECTORS EMERITUS

Loren Anderson, Elkhorn
Thomas H. Barland, Eau Claire
Christopher Berry, Middleton
Bruce T. Block, Bayside
Robert C. Dohmen, Milwaukee
Rockne G. Flowers*, Madison
W. Pharis Horton, Madison
Catherine C. Orton, Mauston
Terri Richards, Duluth, MN
Walter S. Rugland*, Appleton
Carol T. Toussaint, Madison
Rhona E. Vogel, Brookfield
Michael L. Youngman, Milwaukee

WISCONSIN HISTORICAL REAL ESTATE FOUNDATION

OFFICERS

Jonathan Beck, Madison – President
David Wilder, Madison – Vice President
& Treasurer
Joseph Shumow, Madison – Secretary

BOARD MEMBER

Kendall Breunig, Greendale

DIRECTORS EMERITUS

Bruce T. Block, Bayside
Gary Gorman, Fitchburg

**In Memoriam*



Wisconsin Historical
FOUNDATION

FISCAL YEAR ANNUAL REPORT

JULY 1, 2023-JUNE 30, 2024



2024

DIRECTOR'S MESSAGE

Thank you for building the future of history!



DEAR FRIENDS,

As I reflect on the 2024 fiscal year, I am so inspired by what you accomplished. Our dedicated members, supporters and friends made tremendous investments in Wisconsin history over the past year that will pay dividends for generations to come. The progress is astounding, and all I can say is...thank you!

Collectively, you contributed more than \$15.4 million in support of the Wisconsin Historical Society. The Wisconsin Historical Foundation's work as the Society's official nonprofit partner is made entirely possible by your generosity. With your support this past fiscal year, we have reached major milestones and set strong plans for the future.

First, we fully funded the design and construction budget for the Campaign for a New Wisconsin History Center by raising \$48.2 million in generous private support to, in turn, release \$112.3 million in state funding for the project. This goal was achieved thanks to a second incredible \$10 million gift from W. Jerome Frautschi as well as many other generous campaign supporters.

The Foundation is now working to reach our full \$66.5 million private fundraising goal to fully fund exhibit fabrication, program development and transition costs.

Although this flagship project represents a huge accomplishment—there is a lot more to celebrate! We had a record number of new members join the Robert B.L. Murphy Legacy Circle, which recognizes those who have made the decision to leave the Society in their will or estate plans. We launched a statewide sponsorship with Culver's in support of the Society's History Makers Tour, which will travel to all regions of the state through 2027. We also secured \$1.3 million in federal and private grants to support key initiatives across the Society.

In addition to these big achievements, your support as members allows the Society to continue delivering on its mission to collect, preserve and share stories every day. Over the next two years, our organizations are going to stretch and grow as we prepare to open the new Wisconsin History Center, expand operations and guest services across our historic sites and museums, and launch a digital transformation to increase accessibility to the Society's collections. Your support makes these new investments possible while sustaining the core services of the Society to benefit millions of people across the state and beyond.

Your generosity is the foundation upon which we can build all our plans for the future of collecting, preserving and sharing history. Together, we will move these plans forward and achieve great things for our state. Thank you for all you have done, and all you continue to do, to protect our history and share our story.

With deepest gratitude,

A handwritten signature in black ink that reads "Julie Lussier". The signature is fluid and cursive, with the first name "Julie" being more prominent than the last name "Lussier".

Julie Lussier
Executive Director
Wisconsin Historical Foundation

The Wisconsin Historical Foundation is a 501(c)(3) nonprofit organization founded in 1954 to support the Wisconsin Historical Society. The Foundation secures grants and donations, administers the membership program, and provides marketing and communications services on behalf of the Society.

WISCONSIN HISTORICAL FOUNDATION FY2024 FINANCIAL SNAPSHOT

JULY 1, 2023 – JUNE 30, 2024



REVENUE:

\$15,489,730

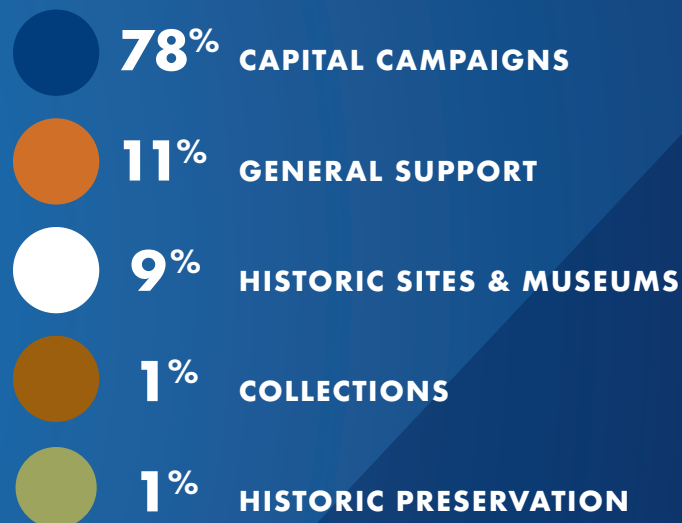

2024 FISCAL YEAR BY THE NUMBERS

FUNDRAISING

11,130 Wisconsin Historical Society members
19 new members of the Robert B.L. Murphy Legacy Circle
\$9,902 raised on the Society's Giving Day
\$22,573 raised on Giving Tuesday
881 new general fund donors
1,459 people gave a gift membership
2,888 new Society members

CAMPAIGN FOR A NEW WISCONSIN HISTORY CENTER

\$53 million
raised to-date
(as of 6/30/24)

\$13.5 million
needed to reach
our goal

\$66.5 million
total private
fundraising goal

MARKETING & COMMUNICATIONS

229,301 followers on Society social media accounts
58 million impressions of Society Facebook posts
7,633,935 unique visits (page views) on wisconsinhistory.org

THANK YOU FOR YOUR SUPPORT!

The following pages recognize the individuals and organizations who contributed a total of \$250 or more to the Wisconsin Historical Foundation from July 1, 2023, to June 30, 2024. This includes pledges and gifts of membership. Your generosity directly supported the work of the Wisconsin Historical Society over the past year and will help set great plans for the future!

Thank you!

SPECIAL THANKS TO THE PRESIDENT'S COUNCIL

President's Council members contribute at least \$5,000 annually to the Wisconsin Historical Foundation. These annual leadership gifts provide critical support to sustain the Wisconsin Historical Society and its consistent delivery of superb programs, resources and services to people across Wisconsin and beyond. Each year, we recognize the generosity of the President's Council with a dinner. Thank you for your visionary leadership and confidence in our mission.

PRESIDENT'S COUNCIL OF THE HERITAGE CIRCLE

\$1,000,000+

Pleasant and Jerry Frautschi

\$500,000 - \$999,999

Richard Searer and
Cathi E. Wiebrecht-Searer

\$100,000 - \$499,999

Anonymous
Thomas and Jill Barland
Erica Fox Gehrig, in honor
of Johanna Heileman
Mary Roelli Hilfiker
Lowell and Mary Peterson
Rhona E. Vogel
Steve and Betsy Wallman

\$50,000 - \$99,999

Diane Dei Rossi and
James Hardy

Robert C. Dohmen

Dick Grum*
William and Jennifer Kraemer
JoAnn and **Michael Youngman**

\$25,000 - \$49,999

Anonymous (2)
Rick Bock Fund of The
Minneapolis Foundation
Dr. Joyce (Carpenter)
Degenhart
Claire and Marjorie Johnson
Roma E. Lenehan
Paul Lenhart and
Maria Fabrega
Jonathan and Susan Lipp
Harold and Christine Mayer
Tom* and Nancy Mohs
Layton and Diane Ridders
Monica Sentoff, in memory
of Stephen Sentoff

The George and Jane
Shinners Charitable Fund,
in memory of Barbara
Shinners Grainger
John and Sherry Stilin
Paul Wertsch

\$10,000 - \$24,999

Anonymous
Jason and Erin Adamany
Rima and Michael Apple
Nancy Marshall Bauer
Bradbury Family
Dennis and Maribeth Dorn
Pat and Anne Fee
W. Lee Hansen
David Hanson and
Linda Bochert
David R. and Darlene A. Lee
Richard and Joan* Leffler
The Lenz Family
Lawrence Midtbo
Linda Pomeroy

Richard A. and
Antoinette M.* Reinhart
Ron* and **Theresa Richards**
Fred and Nancy Risser
Carol and Dean Schroeder
Jay and Katie Sekelsky
Donna and **Tom Shriner**
Leonard Sobczak and
David Pionke
Dawn Stucki
Jane and David* Villa
Kenneth Young, in memory
of Jack Ryan

\$5,000 - \$9,999

Anonymous
Amy Alpine
Angela and Jeff Bartell
Christopher and
Mary Pat **Berry**
Will* and Ruth Bloedow
Kathleen Burke
Bob and **Susan Crane**
Kathryn Maegli Davis
Joel Diemer
Marty and Amy Fields
Barbara N. Fuldner
John and Suzanne* Gilman
Conrad and Sandra Goodkind

**In Memoriam*

Names listed in bold denote members of the WHS Board of Curators, WHF Board of Directors, or Wisconsin Historical Real Estate Foundation Board

Greater Milwaukee Foundation
Freitag Heritage Fund
A. William and **Joanne B. Huelsman** Fund
Jerry and Sherry **Janiszewski**
James and Catherine Koch
Nancy Leach
William Lynch and
Barbara Manger
Audrey* and Rowland*
McClellan
Regina Millner
B. Ann Neviasser
Fred D. Pfening III
Jerald and Mary Phillips
Brian and Karen Rude
John and Linda Schilling
Jim Slattery
Edward and Carol Stevenson
Neal and Cathy Wegner
Eleanor and Fred Winston -
The Longview Foundation
Dr. Jennifer Younger
Richard J. Ziemann Fund of
the Eau Claire Community
Foundation
Thomas and Marykay
Martin Zimbrick

HERITAGE CIRCLE

\$1,200 - \$4,999

Anonymous (5)
Peggy Ahlgren
Loren J. Anderson and
Terri Weiland Anderson
Henry Anderson and
Shirley Levine
Peter and Jo Ann Argersinger

William Baker
Diane Ballweg
Drs. Gita and
Jitendra K. Baruah
Lawrence Bechler
Lawrence and Barbara Behlen
Todd I. and Betty J. Berens
Thomas and Karen Binder
Diane Bless
Bruce and Melissa **Block**
Paula Bonner and
Ann Schaffer
Stephen and Mary Brenton
Anthony and Kay Briski
Thomas and **Mary Buestrin**
Dave and Glenda Buholzer
James and Jean Burgener
Peter and Carol Carstensen
Lau and Bea Christensen
Edward and Robin Culbertson
Dr. and Mrs. Mark J. Curran
Maris and Mary Dambekaln
Bruce Davidson
Judith Daykin
Thomas DeChant and
Paul Gibler
Ellen and Gerald DeMers
James and Jessica Doyle
Megan and Brendon Duffy
Mary Ann and Tom Dyer
Calvin and Janis Edwards
James and Katharine Esser
Dominic Fee, M.D. and
Karin Swartz, M.D.
Patty Fjetland and
Linda Newton
C. Frederick Geilfuss II
and Anne Hamilton

Adam and Carole Glass
Nancy J. Goldberg
James Golz
Ramona A. Gonzalez and
John P. Stuber
Greater Milwaukee
Foundation's Kopmeier
Family Fund
Joel and Jacquie Greiner
Thomas and Ruth Griswold
James E. and
Sharon L. Gutenberger
Vivian L. Guzniczak
Reed and Ellen **Hall**
Anna Biermeier and
Roger Hanson
Ann Louise Harry
Edward and Betty Hasselkus
Bryant Hazard
Carroll Heideman
Diane and Kenneth Heisig
Caralynn Hodgson
Art and Martha Kaemmer
Fund of HRK Foundation
Gregory Huber
Susie Fritz Jablonic
Paul and Sharon Janty
M. J. Jones
Dr. and Mrs. John P. Kaminski
Virginia Kasper
Arlan and Lori* Kay
Frederick P. Kessler* and
Joan F. Kessler
Deborah Kinder
David and Margaret Kraus
Marcella Kremer
Clinton and Louise Kuzmich
Donald and Jean Kwapil

James and Joan Laabs
Dr. Ellen D. Langill* and
Mr. Ross M. Langill
Mark and Ilene* Laufman
Robert J. Lenz
Ronald L. and Jean L. Lewis
Nina Look and Fred Derr
Sheldon and Marianne Lubar
Dave and Sue Lyon
Stewart Macaulay
Laurin Mack and Will Snyder
J. Daniel Maguire
Barbara Fox Mather, in
memory of William Fox
Barbara McFarland and
Kent Carnell
Carole McGuire
Susan McLeod
Ms. Elizabeth J. Meyer and
Mr. Samuel N. Hope
Wes and Caitlin
Mosman Block
Gerald Murray
John K. and Janice W. Notz
Frederick Thomas and
Hope Olson
Margaret Ann Olson
Opitz Family Fund at Madison
Community Foundation
John R. and
Catherine C. Orton
Peter Ostlind
Bob and Holly Ottum
Maura and **Christian Øverland**
Jan Palzkill
Parker Foundation
Allan and Patty Patek
Gary and Peg **Pesicka**



The Wisconsin Historical Society has made significant progress on the new history center over the last year and it has been exciting to watch the design come together. The Wisconsin History Center promises to be a vibrant hub of learning for the state of Wisconsin and one of the leading cultural experiences in the Midwest. I'm proud to support this project and excited to welcome this new addition to Madison's growing cultural district.

W. Jerome Frautschi, Madison, donor to the Wisconsin History Center





Supporting the Society is the right thing to do for someone who values history and how it shapes us. You want to know that you are funding a quality experience for a diverse group of interests. The Society does that. I trust the Society to use my funds with care.

Mary Hilfiker, St. Paul, Minnesota, Wisconsin Historical Society President's Council member and donor to the Wisconsin History Center



Emily and **Daniel Pfeiffer**
Joseph Pfiffner
Rick and Marge Pifer
Robert and Kathleen Poi
Julie Ragland
Anita A. Reid
Janet Robertson
Walter S.* and Amelia M.
Rugland Fund within the
Community Foundation for
the Fox Valley Region
Carol Ann Schlatter
Don and Cindy **Schott**
John Sensenbrenner
Joseph Shumow
Robert and Beverly Spinti
Kathryn A. Steckelberg
Frank Stekel
George and Catherine T. Tesar
Jane A. Bartell and
John W. Thompson
Way and Jacquelyn Thompson
George L. Vogt
Laurie A. Wermter
Charles E. and Ruth Werth
Bob and Sharon Gilson
Richard and Janet Whittow
David Wilder
Kathryn Wilson
Keene T. and Cathy J. **Winters**
Kathleen Woit and
Ron Anderson
Terri and Bill **Yoho**
James Zerwick
Frank and Diane Zillner
Dave and Sandy Zweifel

HISTORY AMBASSADOR

\$500 - \$1,199

Anonymous (3)
Dick Ammann and
Sharon Kelley
Suzanne Ammerman
Mr. and Mrs. Dave Anderson
Lori Ashley and Gary Miller
George Austin and Martha
Vukelich-Austin
Joan Bachleitner
Julie Bader
Robert and Wendy Barr
Chuck Bauer and Chuck
Beckwith
Belinda Bauer
Byron Becker and
Mary Ellen Csuka
James Behling
Jim and Cathy Bembinster
Jane B. Bernhardt
Mary Bethke
Bonnie Birk
Stephanie and
Richard Bloomquist
Roland and Mary Boeding
Kristin Borst and
Timothy Flynn
Ann and Dean Bowles
Susan and William Boyce
Shirley Mattox
Patricia Brady and
Robert Smith
Karen Braun
Barbara Briggs
Lawrence W. Browne, M.D.
Charitable Fund

Brian Buggy
Mary Jo and David Bykowski
Harry and Karen Carlson
Fred and Mildred Carstensen
Carol Lohry Cartwright
Jeffrey and Rhoda **Cheney**
Ellie and Ken Chin
Professor Charles L. Cohen
and Ms. Christine Schindler
Richard Collins and
Dr. Debra Berndt
Barbara Constans and
Deb Rohde
Brian and Mary Cook
Paul Counsell
Ed and Robin Culberston
James H. Damkoehler
Micky Day
Larry and Kathleen Dickerson
Thomas* and Margaret Diehl
Charles and Joan Dorgan
Kathryn Drexler
Sue Ebenreiter
Perry Goetsch and
Barbara Elwood-Goetsch
Nancy J. Emmert
Jeffrey Enders and
Elin Bjorkman
William Engler
Karen and James Evenson
Gretchen Farwell
Rick and Jeanine Fassi
Lynne and Scott Faulkner
Mary Fitzgerald
Susan Flader
Timothy and Joan Flaherty
Jim and Evey Fleming
Jere and Anne Fluno

Joan Fordham
Brenda Fowler
Mark Frankel
Lorraine and Dan Freed
Robertta Gassman and
Lester Pines
Grant and Nancy Gelhar
Dan and Marty Gilbert
Richard Graebner and
Gail Hanson
Greater Milwaukee Foundation
Anthony and Andrea
Bryant Family Fund
Annette J. Roberts and
Joan R. Robertson
Fund for World Peace,
World Law and Peace
Education
Frank and Catherine Greer
Gregory and Carol Griffin
Fritz and Janice Grutzner
Mary Gulbrandsen
Doug and Margaretann Haag
Richard Habermann
Dr. Van Beck Hall
Jane Hamblen
Jean Marie Handley
James Haney
Cheryl Hansen
Cricket Harbeck
Colette Harbort
Charles and Prudie Harker
F. Curtis and Dawn* Hastings
Karen Helwig
Duane Hendrickson
Dale and Linda Herrick
Robert Holland
Thomas and Nancy Holley

**In Memoriam*

Names listed in bold denote members of the WHS Board of Curators, WHF Board of Directors, or Wisconsin Historical Real Estate Foundation Board



Having served as a past president of the Board of Curators, I realize what a unique treasure the Society's collection is to the nation. It gives me a sense of accomplishment to support the Society and provide for future generations.

Judy Nagel, De Pere, Robert B.L. Murphy Legacy Circle member, former Wisconsin Historical Society Board of Curators president



Maxine House and
James Cunningham
Vic and Marty Hren
Marilyn W. John
Dale and Lynn Johnson
Allen Johnson
Antoinette Johnson
William and Dorian Jordan
Maura Jung, Ed.D.
and Kurt Jung
Jeffrey and Elizabeth Kanne
Steve and Lynn Karges
Kehl WauShara Fund,
a Donor Advised Fund
of Renaissance
Charitable Fund
Terry and Mary Kelly
Bernard and Sandra Knesting
Wendy Koepp
Beth Kubly
Linda Kutchman
Mary Ann and
Charles LaBahn
David and Cheryl Lemke
Edward and Lynn Limbach
Marsha Lindsay and
Rick Stone
Heidi Ling
Todd and Julia Loehrl
Dan Loescher
James Luckow
Brad and Julie Lussier
Edward and Ann Mabry
William Madlener
Dr. and Mrs. John J.
Magnuson
Thomas and Cheryl Maxwell
Blair and Joy McMillan
Patricia McQuiddy

Bob Merkel and
Patty Spires-Merkel
James and Patricia Moore
Mr. Stephen Morton
Mary Mowbray and
Roland Schroder
Cindy Nelson
Ronald and Judith Nichols
Daniel Nickolie
William P. O'Connor and
Krista Roys
Galen Olson
Celene Frey and Roy Ostenso
Lyn and John* Otterstein
Mr. and Mrs. August U. Pabst*
Joy Patterson
Mary E. Pautz
A. Gail Phillips
Sue Poullette
John Powell
William Provis
George Purcell
Barbara Putta
Peter Rath
Don and Carol Reeder
Peggy and David Rosenzweig
Ivo and Lindsay Rozendaal
Carla Salmon
Wilbert and Genevieve
Schauer Foundation
Carolyn O. Schloemer
Karl and Judith Schmid
Kevin and Teresa
Schwerdtfeger
Michael Seldomridge
Jerry and Deborah Severson
Janet Seymour
Kathryn Shebiel
Susan Simenz

Elliott Slauson
Alice Stapel
Michael and Therese Stevens
Mary Stott and John Becker
Frederick Stratton
Phillip and Patricia Stroupe
Robert Susedik
Gerald and Vicki Swedish
Donald Sylvester
Sean and Melanie Tafaro
Jo Terlato
Marcia Theusch
Josephine Thiel
Aural Umhoefer
Bonnie Vick
Gerald D. Viste
Diane Wais and
John Wierschem
Ellis and Katie Waller
William and Karen Weber
Ralph and Norma* Wehlitz
George Weidner and
Marilyn Yeates
William Weinshrott
Ronald and Judy Wenger
Faye Whitaker
Linda Whitley
Aimee Wichelt
John and Jean Wiler
Thomas and Shasta Winston -
The Longview Foundation
Stephen and Dawn Wolf
Susan and William Wresch
Phyllis Young
John Gard and **Cate Zeuske**
Steven and Joan Ziegler

HISTORY GUARDIAN

\$250 - \$499

Anonymous (4)
Bill and Andrea Adamany
David and Sarah Allen
Larry Allen
Fernando and Carla Alvarado
Margaret Amend
Sandy and Jeff Anderson
Timothy and Regina Anderson
Joe Andreshak
Marilou* and James Angevine
David Annear
Alice and Richard Appen
Cindy and William Arbiture
Karla and Mark Ashenhurst
Mary Ashley
Paul Aspinwall
Terry and Carol Astin
Roger and Ann Avery
David and Judie Babcock
Jim and Mary Bachhuber
Greg and Cheryl Banks
Leigh Barker Cheesebro
Burton Barnard and
Beatrice Bigony
Robert and Marilyn Bartelme
Charlie Bauer and
Graci Hanson
Donald and
Donna Baumgartner
Marilyn Bazinski and
John Marszal
Jonathan Beck
Ann Becker
James Becker and
Marie Zaczkowski
Timothy and Merri Beckfield

Kevin A. and Wendy M. Behnke	David and La Vonne Callsen	David Flanders and Susan Ecroyd	Robert Hawks
John Bennin	Sharon and Mark Cameli	Janice Fleenor	John Hawley
Steven and Susan Bergin	Peter and Marsha Cannon	Edward Flenz	Anne Hazelwood
Barbara Bergsma	James Carter	Darrell and Sally Foell	Chris Heath
Jon and Char* Bernander	Jean Chapman	Drew and Vicki Fondrk	John and Aimee Hein
Catherine and Donald Bernards	Harold Charlier	Linda and Dennis Fons	John Heinzl and Dawn Roberts
Mary Jo Bernhardt	Michael Cheatham	Kenneth* and Mary Foote	James Heinzen and Heather Avellone
Norman Berven and Barbara Mittelstaedt Berven	James and Nancy Cheski	Sandra Fowler	Matthew Helmerich and Jeffrey Harwell
James Bjornstad and Karen Aasen	Lisa Chessare	Gail and Jerome Fox	James and Barbara Hempel
Pat Blackmer and Daniel Richardson	Jennifer and Martin Chiaverini	Thomas and Leslie France	Earl and Eugenie Hildebrandt
Helen Bleser	Aleta and Walt Chossek	Susan Freistedt	Rosemarie Hodulik and Bruce Hoesly
Thomas Block	Virginia Coburn	Richard and Diane Fronek	Beth Holden and Jerre Ziebelman
Robert and Janet Bocher	J M and Lisamarie Collins	Mary Gage	Steven and Shari Holston
Luke and Lori Bocher	Michael Collins	Deirdre Garton	Peter Homar
Robert Bocher and Mary O'Connor	Joe Conlin	Leland and Beverly Gehrke	Rik and Eileen Homstad
Daniel and Cheryl Boehmke	Ken and Carol Connor	Nancy Geidel	David and Connie Hoogerland
Brenda Bohmann	Mary Jane Connor and Corey Uselman	Charles and Joyce Gelderman	Daniel and Susan Horton
Loren and Deanna Boone	Jane Considine	Brett and Rosalie Gelinsky	James and Cindy Hoyt
Lawrence and JoAnn Borek	Gina and William Copus	Tony and Mary Gentine	Thomas Hruby and Bettina Arnold
Walter and Sandra Borowski	Sue and Jeff Cota	Jean Gessl	William and Jackie Hustad
Dyann and Robert Borremans	Michael and Roberta Couillard	Stephen Gibson and Lisa Hull	Karen Hyde
Jacqueline Borst	Paul and Kristin Covaleski	Karen Gilbert	Stanley and Shirley Inhorn
Kathleen Brand	John and Joann Cross	David and Faith Ginger	Emory and Barbara Ireland
James and Judith Brandt	Tim Cullen	James Goodwin	Jean Jakusz
Paul Muggli and Christine Bremer Muggli	Roger Dahl	James and Sylvia Graefe	David and Patricia Jankoski
Robert and Sharon Brenner	Tracy Dallen	Jane Graf	Wayne Jensen
Elizabeth Briere	Amanda Dambrink	Tony and Linda Granato	Gerald and Jeanette Jessop
S.L. Brooks	Robert Davis	Russ and Edith Grossen	Timothy John and Susan Bisswurm
Ann Brophy and James Brown	Mike and Terri DeMaster	Richard and Kim Groves	Barbara Johnson
Philip and Mary Brown	Michael and Carla Di Iorio	Michael and Laura Grubb	Bruce Johnson
Martha Brown and Wai-chu Lam	Karl and Lisa Dickson	Flores Gumz	Edward Johnson
Michael Bruch	William and Anita Doering	John Gurda and Sonja Nelson-Gurda	Christian Jones and Dian Pinney
Richard and Janice Bruha	Mary Dresser	Christine and Curt Gustafson	Mary Jones
Neal Brunner	Brian Driscoll and Susan French	Jane Hager-Paradowski	Roger Kaas
Barbara Bruno	Alan and Heidi Duerst	Dayle Keitell and Brent Marshall Haglund	Mary Kaczmarek
David Brusky	Jason Dummert	Shirley Haidinger	Charles and Mary Kamps
Alan Bryner	Scott and Becky Dyar	David Haight	Anne and Paul Karch
Ron and Lois Brzezinski	Eric Eddy and Jodie Kulpa-Eddy	Patricia Halpin	Jackie and Len Kaufmann
Ann Buedel	Lisa Ehman	Alice Halpin	Kathleen and William Kean
Douglas and Wendy Buehl	Jean and James Elvekrog	Aaron Halstead	Nancy Kieraldo
Steve and Donna Bultman	Charles and Gail Enoch	Jodi and Steve Hammer	Rolf Killingstad
Coleen Burns	Karen and Tom Erger	Collier Hands	Lawrence Kirkwood
Karoliina Bursian	Carl Eschweiler	John and Barbara Hanisch	Christopher and Margaret Kleinhenz
Michael Butash	Diane Färdig	Ed and Celia Harker	
	Scott Feiner	Beth Harper	
	Dennis and Karen Fenske	Gary and Marie Harrison	
	Paul and Katherine Fernholz	Steve and Bette Hartley	
	Meghan and Thomas Findley	John and Sally Hattenhauer	
	Sandra Fisher	Mary Hauser	

**In Memoriam*

Names listed in bold denote members of the WHS Board of Curators, WHF Board of Directors, or Wisconsin Historical Real Estate Foundation Board

Penelope Klitzkie
 Jeff and Jessica Kloth
 Brian and Janet Knoch
 David Knoke
 Gregory Knoke
 Paul and Suzanne Koehl
 Robert Koehler
 Sarah Koeppen and
 Zach Tranmer
 Roger Koester
 Joseph Kollar
 William and Betty Komula
 Allan and Kathy Koritzinsky
 Mary Krall
 James Krueger
 Ron and Winnie Krueger
 Lawrence and Sylvia Kruger
 Kenneth and Priscilla Kuehn
 Hans Kuhn and
 Nanette Bulebosh
 William L. Kundert
 Barbara Kurten
 Harold and Grace Kurtz
 Eric and Marissa La Brecque
 Marvin Lansing and
 Nancy Kraft
 Angela and Jamie Larse
 Paul and Margaret Larson
 Del Laughlin
 Elizabeth Lawrence
 Michael and Rochelle Layde
 Linda Learn and
 Andy Loughlin
 James Leary and
 Janet Gilmore
 Michael and Margaret Lenth
 Mary Jo and Dennis Leveque
 Stuart D. Levitan

W. and Mary Ley
 Allen and Joan Liegel
 Mark and Celine Lillie
 Mark Loppnow
 George and Emily Lorenz
 Nancy and Andrew Lucas
 Sean and Sarah Luedke
 Wayne and Linda Luft
 Ron and Kay Maassen
 Lois Malawsky
 William Malone
 Jeanne Marking
 Michael and
 Christine Martens
 Donald and Gail Marti
 Carl and Ann Martin
 Kathleen Martin
 Larry Martin and
 Martha Cranley
 Mark and Karla Martinez
 Francis and
 Rose Mary Matusinec
 Raymond and
 Maureen Mazurek
 Mary McAndrews
 John and Marian McClellan
 Bill McClure
 Mark and Jana McCluskey
 Frederick and
 Virginia McCormick
 Mary Anne McCoy
 John and Susan McFadden
 Hildegard McGown
 Jonathan Mckey
 Joan and Rick McLaughlin
 John McNamara
 Nancy Mengelt
 Anthony and Stacy Menting

Bill and Joycel Messer
 Frederick and
 Karen Mikolajewski
 Matthew Mikolajewski
 Sharla Miller
 Andrew and Cheri Miller
 Chad and Angela Miller
 Stuart Moebus and Gail Ostler
 David V. Mollenhoff
 Greg and Christina Moratz
 Robert Rogers and
 Kelly Moravec
 Bill and Pat Moren
 Carol Mosher
 Paul and Louise Murphey
 Frederick and
 Mary Ellen Muth
 Donna Myers
 Arthur and Nancy Nesbitt
 Willard and June Nettles
 Adam and Rebekah Nofsinger
 Lillian Nolan
 Gary Nosacek and
 Cynthia Jones-Nosacek
 Richard and Peggy Notebaert
 Alexandria Novak
 Lynn Nyhart and
 Thomas Broman
 Marilyn Oberst
 Gregory and Cindy Odden
 Deanne Olson
 Thomas and Ginny Olson
 Tammy and Joel Opprieht
 James and Sandra Pape
 Lawrence Paplham
 Mark and Kathy Parsons
 Patricia Paska
 Sandra Paske

Justus F. Paul
 Thomas and Florence Paulin
 John and Cathy Pederson
 Angela Penzkover
 Sue Perkins
 Ernest Peterson
 W. Thatcher and Joanne
 Peterson
 Richard J. Phelps
 Ray and Loretta* Piehl
 Brad and Louise Pokorny
 Jim and Margaret Polglaze
 David and Donna Poortenga
 Judy Poplawski
 Jay Poster
 Keith and Antoinette Powell
 Eileen and Stanley Presley
 Fred and Diann Pribbernow
 James and Frances Proulx
 Al and Paula Putirskis
 Joseph Quinn
 Deborah Radzak
 John and Lorie Raihala
 Joseph Ranney
 Steven and Vivian Ratfelders
 Kenneth and Susan Reese
 James and Tanya Reilly
 Theodore and Janet Reinke
 Jane Reynolds
 Daniel Reynolds and
 Laura Wagner
 Chris and Elaine Rich
 Dale Rindfleisch
Karl and Catherine Robe
 Betty Jane Roethle
 Albert Romportl
 Maureen Rooney
 Joyce Rosenberg



**Understanding our history helps us make a better future,
 and the Society makes that possible. It makes me feel
 proud to know that I am making an important difference
 by supporting this valued work.**

Terri Richards, Duluth, Minnesota, Robert B.L. Murphy Legacy Circle member,
 Wisconsin Historical Society President's Council member, Wisconsin
 Historical Foundation director emerita and former board chair





The Society does amazing work in preserving the rich history of Wisconsin and its residents. (It) has shown a focus on telling the stories of often-forgotten groups of people, which drew our attention. We want to make sure part of our estate is used to help organizations doing this important work.

Barb Constans & Deb Rohde, Madison, Robert B.L. Murphy Legacy Circle members



Karyl Rosenberg
Deborah and
Carl Ruedebusch
Finn Ryan and Brynn Bemis
Gail Ryan
Kathleen Ryan Johnston
Muhammad Isa Sadlon
Anthony and Kathleen Saiia
Jesús Salas
David Saloutos
Louann Sanchez
Richard Schallert and
Mary Brefeld
Sarah Schaub
David and Judy Schendlinger
Donald Schenker
Robert and Constance Schiele
Christine Schlosser
Alan Schneider
Diane Schuck
Joe and Dorothy Schuller
Allan and Wendy Schultz
Girard and Nancy Schultz
James and Carolee Schultz
Peter and Diane Schumacher
Robert Schuricht
Ann Scott
Thomas and
Meredith Scrivner
Jeri Sebo
James and Noreen Seegers
Michael and Janice Shucha
Judith Sikora
Dennis Slater
Cameron and Jen Smith
Cynthia Smith

Enoch Smith
Gail Smith
John and Judith Smith
Mike Smith and Leanne Olson
Georgia and Kenneth Snoke
Robert Sommerfeldt
Robert and Kathy Spargo
Ron and Jennifer Spielman
Dan and Joy Stair
Courtney Stangl
Robert and Jessie Stauffacher
Phillip and Jeanne Stefoni
Allan and Mary Stegemann
Paul Steger
Darlene Sterzinger
William and Sally Stevens
Norman Stewart
Patricia and Charles Stinger
Vaughn and Lori Stock
Marc and Beth Storch
Clara Strasser
Ron and Tracy Strickland
Todd Stuart
Thomas and Marilyn Swiontek
Linda and George Tanner
Judith Taylor
Veronica Telfer
Dean and Michele Teofilo
Nancy and Randy Thelen
William and Barbara Thiel
Eric and Sally Thomas
Philip and Jane Thorick
Lawrence Totsky
John and Willeen Tretheway
Margaret and Mark Tritschler
Karolyn and Hugo Tscharnack

Edwin and Jo Turner
Gregg and Karla Tylke
James and Emily Uhlenhake
Michael and
Margaret* Uihlein
Nancy Unger
Earl Updike
Michael Vahldieck and
Julie Horner
Louise Valdovinos
Maureen C. Van Dinter
Jacqueline and Alex Vaver
Andrew and Lisa Vedder
Aina Vilumsons
James Walker
Lorette Wambach
Elaine Waraczynski
James Warczak
Nadine and Michael Waszak
Dave and Deb Watson
Paul and Donna Watson
Charles Wegner
Julia Wegner
Carol Weiland
Donna Weis
Mark and Anne Weitenbeck
Corinne and Nancy Westmas
Scott Whiteford
Sandy Wiegand
Charles and Pamela Wilhelm
Jay and Katie Williams
Linda Williams
Gail Wiltgen
Belinda and
Matthew Windisch
Dean and Nettie Witter

David Wood and
Jane Doughty
Laura and Gregory Yanchenko
Peter and Sharon Calder
Tom and Karen Zilavy

SUPPORTING PARTNER

Supporting Partners provide highly valuable contributions needed for the ongoing success of Society programs and services. Contact Nick Clarksen to learn how your organization can participate. Call 608-263-3548 or email nicholas.clarksen@wisconsinhistory.org.

\$500,000+

Kohler Trust for Preservation
State of Wisconsin

\$100,000 - \$499,999

Alliant Energy Foundation
Ruth and Hartley Barker
Advised Fund through
Encourage Community
Foundation
Cleary-Kumm
Foundation, Inc.
Ray and Kay Eckstein
Charitable Trust
Navistar
Urban Land Interests, LLC

**In Memoriam*

Names listed in bold denote members of the WHS Board of Curators, WHF Board of Directors, or Wisconsin Historical Real Estate Foundation Board

I have always been interested in history. My father was interested. My son and grandson are interested. We are four generations of history buffs. Is it hereditary? I'm interested in Wisconsin history for sure, European history, and family history. We took our children to historical sites from a young age and later our grandchildren. Old World Wisconsin and the Hoard Museum in Fort Atkinson were favorites. I have visited every Wisconsin Historical Society Site except one or two and many local historical sites around the state. I have enjoyed each one!

Karolyn Alexander Tscharnack, Whitewater, Wisconsin Historical Society member for 33 years



\$50,000 - \$99,999

Culver's
Black Point Historic
Preserve Operation and
Maintenance Fund at
the Greater Milwaukee
Foundation
Ruth Foundation for the Arts

\$25,000 - \$49,999

The Lynde and Harry
Bradley Foundation
Charles G. Swem Trust
Circus World Museum, Inc.
Estate of John H. Englesby
Kohler Foundation, Inc.
Irving & Dorothy Levy
Family Foundation Inc.
Old World Foundation

\$10,000 - \$24,999

Anonymous (2)
American Family Insurance
The Edwin E. & Janet L.
Bryant Foundation
The Comer Family Foundation
The Evjue Foundation, Inc.,
the charitable arm of
The Capital Times
National Guardian Life
Insurance Company
Jane Bradley
Pettit Foundation
William G. Pomeroy
Foundation
Gregory C. Van Wie
Charitable Foundation
George H. and Nancy R. Vogt
Foundation
von Briesen & Roper, s.c.

Wisconsin Preservation
Fund, Inc.
Wisconsin Canoe Heritage
Museum

\$5,000 - \$9,999

American Girl
Estate of Jack McManus
First Business Bank
John J. Frautschi Family
Foundation
Walter A. and Dorothy Jones
Frautschi Charitable
Unitrust
Friends of the Madeline
Island Museum
Gorenstein Charitable
Foundation, Inc.
Greater Milwaukee Foundation
Black Point Horticulture
Fund
Freitag Heritage Fund
Walter A. Wilde Fund
Iowa County Land
Conservation
Kohler Co.
Stafford Rosenbaum LLP
Thorson Foundation, in
memory of John C.
Goodall, Jr.
WaterStone Bank
\$1,200 - \$4,999
Alpha Investment Consulting
Group, LLC
The Coburn Company, Inc.
Margaret Heminway Wells
Fund at the Greater
Milwaukee Foundation

The Donna M. Kalnes Fund of
Thrivent Charitable Impact
& Investing
Kikkoman Foods
Foundation, Inc.
Lake Geneva Garden Club
Foundation, Inc
Black Point Preservation Fund
at the Madison Community
Foundation
Murphy Desmond S.C.
R. J. Williams Questers #1288
University of Wisconsin -
Madison
Vilter Foundation

\$500 - \$1,199

Anonymous
Beaver Dam
Community Library
Briess Malt & Ingredients Co.
Brookfield Public Library
Burlington Public Library
Carter Memorial Library
Cudahy Family Library
Culver's - Madison,
Mineral Point Rd
Deppe Enterprises
Dwight Foster Public Library
Friends of H.H. Bennett
Studio
Geneva Lake Museum
Greater Milwaukee Foundation
Briggs & Stratton Fund
Cottrell Balding Fund
Greendale Public Library
Sue Anne Gelatt Foundation
Jack Russell Memorial Library
Jefferson Public Library

Johnson Creek Public Library
Juneau Public Library
Lake Geneva Public Library
Matheson Memorial Library
Menomonee Falls
Public Library
MSA Professional Services
Mukwonago Community
Library
New Berlin Public Library
Oconomowoc Public Library
Pauline Haass Public Library
Powers Memorial Library
Rochester WI Public Library
Rock County Genealogical
Society
Schreiner Memorial Library
St. Francis Public Library
E.C. Styberg Foundation, Inc.
Ted & Grace Bachhuber
Memorial Library
Teel Plastics
Vietnam Veterans Against
the War
Watertown Public Library
Waukesha Public Library
Whitefish Bay Public Library

\$250 - \$499

D.L. Gasser Construction
Geneva Lakes Family YMCA
Hook's Cheese Company
Northern Lake Service, Inc.
Raised Grain Brewing Co.
Rotary Club of Madison
Ygdrasil Literary Society of
Madison, Inc.

WISCONSIN HISTORICAL FOUNDATION ENDOWMENT FUNDS

These endowment funds were established to provide ongoing support to the Society and its divisions, programs and operations. This source of annual support is critical to the sustainability and financial security of the Society and its work.

Allan and Margaret Bogue Endowment for Archives Processing
Amy Louise Hunter Fellowship Endowment
Black Point Historic Site Preservation Fund
Board Designated Unrestricted Endowment
Brooks McCormick Fund
Circus World Museum Foundation Library Endowment
Daniel Steele Durrie Endowment
Danky Fellowship Endowment Fund

Deke Slayton Memorial Space & Bicycle Museum Endowment
Evelyn A. Krueger Endowment Fund
Friends of H.H. Bennett Studio Endowment
Fuldner Heritage Fund
Fuldner Technical Education Endowment
George Banta Director Fund
Gerald and Prudence Craig Endowment Fund
Gleason Genealogy Endowment
Grants-in-Aid Travel Scholarship Endowment
Helmut R. and Nancy M. Bauer Endowment Fund
Hesseltine Endowment
John C. Geilfuss Endowment
K-12 Education Endowment Library and Archives Preservation Endowment Fund
Local History Grant Endowment
Mary C. Hoard Endowment Fund
Mead Witter Preservation Endowment
National History Day Endowment

Northern Great Lakes Visitor Center Endowment Fund
Reed School Historic Site Endowment
Richard and Joan Leffler Endowment
Rima and Michael Apple Archives Endowment
Robert A. and Dorothy H. Luening Fund
Ruth DeYoung Kohler II Fund
Ruth Ketterer Harris Endowment
Scott M. Cutlip Endowment Fund
Social History Endowment
Society Library Endowment
St. Croix Falls Investment Fund
The Old World Wisconsin - Caldwell Hall Fund
The Ralph and Virginia Kurtzman Fund for National History Day in Wisconsin
Vernon Carstensen Endowment Fund
Wade House Endowment
Early American History Lecture Series Endowment
WI Canoe Heritage Endowment

FEDERAL GRANTS

The Wisconsin Historical Society was awarded the following federal grant awards in fiscal year 2024.

Museums for America Grant from the Institute of Museum and Library Services
Save America's Treasures Grant from the Institute of Museum and Library Services
University of Wisconsin Sea Grant College Program funded through the National Oceanic and Atmospheric Administration, Department of Commerce, National Sea Grant College Program
Wisconsin Coastal Management Program Grant from the National Oceanic and Atmospheric Administration
State Board Programming Grant from the National Historical Publications and Records Commission of the National Archives

**In Memoriam*

Names listed in bold denote members of the WHS Board of Curators, WHF Board of Directors, or Wisconsin Historical Real Estate Foundation Board



Through National History Day, students become experts in a specific part of history which can create confidence and build self-esteem. I think that was maybe the most rewarding part for me. I got to the point where I knew my paper better than the back of my hand and could argue my points using dates and details without needing to look at it. My paper gave me a deep sense of accomplishment, and I think overall that is the most important thing.

Arianna George, 8th grade, NHD Nationals Outstanding Entry award recipient



LIFETIME IMPACT DONORS

Active donors who have contributed since July 1, 2019, and have given a total of \$100,000 or more.

Alliant Energy Foundation
American Girl
Diane Ballweg
Thomas and Jill Barland
Nancy Marshall Bauer
Christopher and Mary Pat Berry
Bruce and Melissa Block
Will* and Ruth Bloedow
The Boldt Company
Renee and **Tom Boldt**
The Lynde and Harry Bradley Foundation
Cleary-Kumm Family
The Comer Family Foundation
Mary C. Pierce
Bob and **Susan Crane**
Mr. Craig C. Culver
Diane Dei Rossi and James Hardy
Robert C. Dohmen
Ray and Kay Eckstein Charitable Trust
Dan and Natalie Erdman
The Evjue Foundation, Inc., the charitable arm of *The Capital Times*
Pat and Anne Fee
Patty Fjetland

Rockne* and JoAnne **Flowers**
Pleasant and Jerry Frautschi
John J. Frautschi Family Foundation
Walter A. and Dorothy Jones Frautschi Charitable Unitrust
FRIENDS of the Wisconsin Historical Society
Erica Fox Gehrig, in honor of Johanna Heileman
Conrad and Sandra Goodkind
Greater Milwaukee Foundation, Inc.
Robert* and Elke Hagge
Mary Roelli Hilfiker
Carolyn* and **Pharis Horton**
A. William and **Joanne B. Huelsman** Fund at the Greater Milwaukee Foundation
Jeffris Family Foundation Ltd.
Claire and Marjorie Johnson
Maura Jung, Ed.D. and Kurt Jung
Kikkoman Foods Foundation, Inc.
Ruth DeYoung Kohler II* Kohler Co.
Kohler Foundation, Inc.
Kohler Trust for Preservation
William and Jennifer Kraemer
Mark and Ilene* Laufman
Dale Leibowitz and Ron Suliteanu
The Lenz Family

Irving & Dorothy Levy Family Foundation Inc.
Madison Community Foundation
Audrey* and Rowland* McClellan
Mead Witter Foundation, Inc.
Lawrence Midtbo
Mr. Fred and Mrs. Mary* Mohs
Tom* and Nancy Mohs
Navistar
David L. and Rita E. Nelson Family Fund within the Community Foundation for the Fox Valley Region, Inc.
Lowell and Mary Peterson
Jane Bradley Pettit Foundation
Fred D. Pfening III
RDK Foundation
Walt* and Milly **Rugland**
Sally Mead Hands Foundation
Don and Cindy Schott
The George and Jane Shinnars Charitable Fund
Dawn Stucki
Jane A. Bartell and **John W. Thompson**
Thorson Foundation
U.S. Bank Foundation
Urban Land Interests, LLC
Gregory C. Van Wie Charitable Foundation
Rhona E. Vogel
Steve and Betsy Wallman
We Energies

Richard Searer and **Cathi E. Wiebrecht-Searer**
Wisconsin Canoe Heritage Museum
Wisconsin Preservation Fund, Inc.
JoAnn and **Michael Youngman**

LONGTIME CONTRIBUTORS

Those who have generously contributed for at least 25 consecutive years.

Donna Abell
Nancy Abraham
Frederic and Mary Ellen Ackerson
George R. Affeldt, Jr.
Lois Alfson
Betty Allen
David and Sarah Allen
Carolyn Allison
Joey Amberg
American Girl
Frank Amundson
Henry Anderson and Shirley Levine
Debra Anderson
Trish Andrae
Irmgard Andrew
Marilou* and James Angevine
Rima and Michael Apple
Barbara Arntz
David H. and Nancy K. Aronson



Thank you for making an investment in education through your support of National History Day. A program like NHD makes the possibilities endless and sets our students free to direct their own learning. The opportunities here are boundless and we owe it to our students to let them discover and uncover the kinds of stories that may just change their lives.

Naomi Peuse, MLIS, Librarian & NHD educator, Weyauwega-Fremont School District



Terry and Carol Astin	John Broihahn and	Gerald and Mary De Amico	William and Nancy Foshag
Bernard and Betty Backus	Gabriele Lubach	Judy and John DeCoster	John Fournelle and
Carl and Ellen Baehr	Elizabeth Brown	Ronald and Margaret Delaney	Judith Munaker*
Robert and Barbara Bakke	Richard and Kathleen Bruce	Loretta and Cletus Delvaux	Evelyn Fox
Bernice Balicki	Thomas L. Bruckner	Ellen and Gerald DeMers	Robert and Bernadette Frank
Thomas and Jill Barland	Richard and Janice Bruha	Richard and Sue Dexheimer	Steven and Linda Franz
Patricia Barnes Putnam	Mae Bryant	Daniel Dexter	Barbara and Jeffery Franzen
Robert Barr	Ken and Lucy Buchholz	Eleanor Dockry	John and Betsy Freiburger
James Bartelme	Douglas and Wendy Buehl	Dodge Centre	Mark and Ilona Fridl
Mona Barwick	Bruce and Lynn Buhmann	Historical Society	Richard Fried
Linnea Bass	Ernst Bunde	Robert and Emogene	Barbara Froemming
Wendy Bass	John and Susan Campbell	Dodsworth	Richard and Diane Fronek
Judith Bates	Kathleen and Paul Campbell	William and Anita Doering	Susan Fulks
Carl and Arlene Baumann	Peter and Marsha Cannon	Ann and Joe Dorgan	Barbara Furstenberg
Mary Bayorgeon	William and Nancy Carpenter	Dennis Doty	Terry and Judy Gaddess
David and Patti Becker	Peter and Carol Carstensen	Marie Drescher	Donna Gager
Joseph and Dorothy Becker	Mark and Kathie Cellotti	Thomas and Joan Dunn	Dale and Janet Gaugert
Kevin A. and	Kathryn Cervenka	Gordon Dunn	Lee and Janice Gehrke
Wendy M. Behnke	Jean Chapman	Alan and Elizabeth Dunwiddie	Leland and Beverly Gehrke
James and Lois Benes	Evonna Cheetham	Ruth Duxbury	Donnell and Sheila Geib
Robert* and Mary Bennett	Vernon Christiansen	Stephen and Dorothy Earp	Mary Gibson
John Bennin	Roy and Sara Christianson	Tim and Cindy Eberhardy	Sandy Gilbertson
Kathleen Bergan Schmidt	Charles and Karen Church	Judith L. Eckert	James and Arlene Gill
Ronald and Kris Berman	Angela Cina	Allan and Joyce Eggleston	Mark and Marlene Gilmore
Jane B. Bernhardt	Caroline Clark	Jayne Englebert	David and Faith Ginger
Margaret and Michael Berres	John Clarke	John H. Englesby Estate	Brian Ginsbach
Dennis and Barbara Best	Allan Clauer	Patricia Esch	Gary Gisselman
Thomas Betka	Verallyn Cline	Judy and Dave Eulberg	Alicia L.* and
Janet Beuthin*	Professor Charles L. Cohen	Rose Fahien	Jerry D. Goehring
Linda Beyer	and Ms. Christine Schindler	Linda Fahrenkrug	Eleanor Gojmerac
John and Linda Binder	Marshall and Arlene Colburn	Farmers & Merchants	James Golz
Thomas and Karen Binder	Donald Cole	Union Bank	James Goodwin
Durand and	Mary Jo Cole	William and Colleen Feist	Michael Gordon and
Mary Ellen* Blanding	Robin Comeau	Robert and Catherine Felber	Michele Sumara
Stephen and Carol Blattner	Mary C. Pierce	Paul and Katherine Fernholz	Sharon and Laurence Goss
Helen Bleser	J. Frank and Mary Ann Cook	Larry and Sue Ferry	Mary Gosse
Wilmer Bloy	Leonard and Shirley Coombs	James and Donna Field	Virginia Gostomski
Michael and Kathleen Bolton	Janet Cooper	Matt Figi	Robert and Deborah Gough
James Bonnett	Robert and Diane Cowan	Mary Ann Finke	Dan and Karen Graff
Lawrence and JoAnn Borek	Gary and Debra Cowles	Ted and Janet Finn	Stephen Gries
Kathryn Borkowski	John and Joann Cross	Barbara Fisher	Kenneth and Carol* Grode
Barbara Borns	Andrew Crummy	John Fleckner and	Richard and
Dr. Mark S. Bostwick	Carol and Stephen Culbertson	Laura Feller	Deanna Guenther
Jerry and Donna Bower	Lois Curtiss	Jim and Evey Fleming	Flores Gumz
Rev. Douglas Brandt	George Cutlip	Edward Flenz	John Gurda and
Kathleen Braun	Douglas Dams	Rockne* and JoAnne Flowers	Sonja Nelson-Gurda
Caryl Bremer*	Katie Daniels	Darrell and Sally Foell	Anna Guse
Ron and Doris Brewster	Annette Daniels	William and Ellen Follmann	Robert Guth
James and Elizabeth Brezinski	Richard and Constance	Russ and Linda Forbess	Vivian L. Guzniczak
Michael K. Bridgeman	Danielson	Sarah Ford and	Gerald and Marilyn Hahn
William and Sue Bridson	Patricia Daubs	Randall Klumb	Steve and Joanne Hahn
	Donald Davis*	John and Roberta Fosdal	Walter and Patricia Hahn

*In Memoriam

Names listed in bold denote members of the WHS Board of Curators, WHF Board of Directors, or Wisconsin Historical Real Estate Foundation Board

Ginny Hall	David Hoeveler	Kathryn and Tom Kammerude	James and Joan Laabs
Patricia Halpin	John Hoffmann	Jeffrey and R.L. Kannel	Mary Lagerbloom
Jeff Hansen	Rita Honnold	Donnelle Kappel	James and Harriet Laird
Robert Hansen	Carolyn* and Pharis Horton	Lois Karn	Virginia and Norman Lange
Wayne and Janet Hanson	Raymond Horvath	Ronald Karzel	Mark and Lynn Langenfeld
Allen Hanson and Cynthia Cina	Bernard and Roberta Hotzel	Anne Kasuboski	Edward Langer
Colette Harbort	Kent and Marilyn Houck	Joanne Kelly	Marvin Lansing and Nancy Kraft
Robert and Ruth Harker	Thomas Hruby and Bettina Arnold	Carol Kemen	Zoe and J. T. Lappin
Reid and Patricia Harrsch	Clifford and Mildred Huck	Ronald Kent and Sara Markham	Karen Larson
Forrest Hartmann	Mary Huck	Frederick P. Kessler* and Joan F. Kessler	Brian and Mildred Larson
Steven and Rae Jean Hartzell	Timothy Hughes	G. Curt and Mary Kiessling	Michael Lawton
Edward and Betty Hasselkus	Roger Hunt	John and Irene Kinna	Bernard and Judith Leanna
Anthony Haswell	Kirsten Husband	James and Laura Kirchberg	Nancy and Charles Leathers
Charles and Gwendolyn Hatfield	Stanley and Shirley Inhorn	Madge and Albert Klais	Leslie Lee
John and Sally Hattenhauer	Susie Fritz Jablonic	Mary Klein	David R. and Darlene A. Lee
Robert Hawks	Thomas Jablonsky	Dorothy Klinefelter	Patricia and Robert Leiskau
Donald Hebl*	Jeffrey Jacobs	Joyce Knutson	David and Cheryl Lemke
Timothy Heggland	Ronald Jacobs	Holly and Thomas Kobza	Roma E. Lenehan
Walter and Laurel Heil	James and Margaret Jagler	Melvin and Shirley Koenigs	Mark Lederer and Lynn Levin
Loran Hein	David and Patricia Jankoski	Kohler Foundation, Inc.	Mark Liebhauser
Kelli and Martin Heindel	Kathryn Jaschinski	William and Betty Komula	David and Kathleen Lieburn
John and Kimberly Heinisch	Gerald and Jeanette Jessop	Nancy Kopp	Robert Lindvall
Ronald and Pat Heinritz	James Jewell	James Koslowski	William Listwan
William Helsabeck	Marilyn W. John	James Krauklis	Ardala Littlefield
Gerald Henry	Antoinette Johnson	Richard Kraus	Peter Lovance
William Hentzen	George and Edna Johnson	Thomas and Margie Krauskopf	Robert and Donna Lucht
Gilbert and Karen Herman	James and Patricia Johnson	Anne Krischke	Daniel Ludwig
Joe Hermolin	Mary Jane Johnson	Brian Krueger	David and Marjory Lyford
Steve Herschleb	William and Lisa Johnson	Carl Krumhardt	John Mack
John Hess	Lee and Rosemary Jones	Kenneth and Priscilla Kuehn	Rodney and Mary Malinowski
Earl and Eugenie Hildebrandt	Mary Jones	Thomas and Carolyn Kurtz	William* and Caroline Mallatt
Victor and Patricia Hilts	Milo and Joan Jones	Hildegard Kuse	Marcia Manning Griskavich and Walter Griskavich
Mary Carolyn Hoag	Joseph Jopek	La Crosse Area Genealogical Society, Inc.	Andrew and Linda Marcinowski
Randall and Donnalee Hoelzen	Eleanor A. Jung		
	Phillip Kallas		
	Dr. and Mrs. John P. Kaminski		



Our annual field trip to the Wisconsin State Historical Society's Maker Space tops our list every year because of the immersive, hands-on activities that truly bring history to life. The Maker Space allows students to engage with history in a tactile way, helping them move beyond the textbooks and into real-world experiences. When students can touch, hold, or recreate historical items, it sparks their curiosity and deepens their understanding of the past.

Carol Patterson, fourth grade teacher, Tower Rock Elementary, Sauk Prairie School District



Terry Marshall and Lesley Johnson	Dan Mittag and Karen Mitchell Mittag	Frederick Thomas and Hope Olson	Christopher and Sandra Queram
Bruce and Susan Marshall	Marjorie Mlodzik	Lee and Kathleen Olson	Richard Quinney
Mary Martin	James Moeller	Erhard Opsahl	John Race
Kert and Ruth Marty	Donald and Mary Mollet	Kent Orlandini	Ruth Rand
Marlene and Gerald Marx	Robert Mory	Nancy R. Osmolak	Steven and Vivian Ratfelders
John Marx	Michael and Diane Mueller	James Ostrander	James S. Reeve and Ann Wartinbee Reeve
Sarah Marx	Robert and Glenness Mueller	Gerald and Marjorie Pagel	Anita A. Reid
Robert and Charlotte Matzek	Elizabeth Mullins	Pamela Palmer	Gerald Reif
Mary McAndrews	Tess Mulrooney	Marvin and Laura Paluszynski	James and Barbara Rice
Peter and Mary McCanna	Sally Mundt*	Susan and Steven Pamperin	John and Alice Ridge
Jeffrey and Maria McCartney	Sally Munley	Patricia Paska	Gordon and Susan Ridley
John and Marian McClellan	Frederick and Mary Ellen Muth	Allan and Patty Patek	Mary Rieder
Tom* and Geraldine McCormick	Joseph Nagle	Sue and Oscar Patrick	Ken Riedl
Joanne McDonald	Barbara Nagy and Mark Oefinger	Nancy J. Patterson	Dale Rindfleisch
Jere McGaffey	Gerald and Jeanne Neath	John and Cheryl Pearse	Susan Ringer
Hildegard McGown	Richard Nelson and Catherine Morris-Nelson	Kristen Peil	June Rinka
Mac McKichan	Thomas and Susan Nelson	Frank Peot	Lois Ristow
Neal and Ann McLain	Earl Newton	Donald and Ann Peotter	Charlene Ritchey
James and Leslie McLeer	Ronald and Judith Nichols	Sheree and Philip Peterson	Louise Robbins
Paula Meiers	Joan and Dick Niemiec	Daloris Pfister	Bill Robersen
Jack* and Mary Melrose	Beth Nienow	Joan Phelan	Susan Robinson
William* and Esther Merckel	Larry and Katherine Nix	Gene and Sonia Phillips	Thomas and Pamela Robson
John Merriman	John and Jill Norton	Ray and Loretta* Piehl	Dennis Rocheleau
Charles Merten	John O'Connell*	Richard and Ann Piehl	Jon and Susan Ronning
Harold and Jane Milller	Dolores O'Laughlin	Rick and Marge Pifer	Joyce Rosenberg
Nadine and Samuel Miller	William and Jean O'Loughlin	Patricia Popple	Karyl Rosenberg
Terry Mesch and Lori Miller	Robert and Carol Olsen	Guy Porth	Dan and Cheryl Ross
Marveen Minish	Keith Olson	Angela Powell	Francis and Carlyn Rott
Jerry and Maureen Minnick	Margaret Ann Olson	John Powles	Pamela Ruben
Robert and Nancy Mitchell		Eileen and Stanley Presley	Brian and Karen Rude
		Alice Punwar	Lynn A. Rusch
		Richard and Sharon Quale	

**In Memoriam*

Names listed in bold denote members of the WHS Board of Curators, WHF Board of Directors, or Wisconsin Historical Real Estate Foundation Board



Last year we moved from Oklahoma to Wisconsin. I am glad to be a member of the Society and look forward to exploring more of its historic sites. Last summer we visited Old World Wisconsin. I also appreciate the reciprocal museum benefit that comes with my membership. I used it when my family visited the Abraham Lincoln Presidential Library and Museum in Springfield, Illinois.

Paula Keefer, Brookfield, Wisconsin Historical Society member



Jeffrey and Linda Russell	Alan and Mary Siggelkow	Mary Thompson	Nancy Watenphul
Erica and Michael San Dretto	Mary and John Silbersack	James and Kathleen Thunes	We Energies Foundation
Frank and Barbara Sandberg	Deborah and David Simms	Todd and Ludmila Tischer	David and Mary Webster
Ruth Sanderson	Bhagat Singh	David and Nancy Topp	Eugene Weeden
Norman Schaefer and	Jerome Sjostrom	Mary Torke	William Weinshrott
Carrie Fintel	Raymond Smerz and	John and Carol Toussaint	Walter and Nancy Weirich
Philip and Cynthia Schaffner	Kathleen Egan	Debra Bailey Trail	Suzanne Weisman
James Schaible and	Darrell Smith	James and Bernie Treichel	Thelma Wells
Georgene Agnich	Gail Smith	John and Willeen Tretheway	Elaine Wendt
Robert and Joan Schaupp	Wilma Smith	Neil and Rebecca Trilling	Richard Werking
Linda Schiesser	Richard and Elizabeth Snyder	Elinor Trosin	Charles E. and Ruth Werth
Carolyn O. Schloemer	Robert J. Spinti	Dennis Trudell and	Carol Wetzel
Peter and Nancy Schmalz	Edward Spitzbarth and	Dee Grimsrud	Gary Wetzel
Ronald Schneider	Lynn Milbrath	Richard Tvedten	Calvin Wheeler Jr.
Lillian Schouten	Richard Staff	Phillip and Mary Tygum	J. Craig Whitcomb
Ronald and Mary Schuelke	Alice Stapel	Aural Marie Umhoefer	Jo Wickstrom
Joan Schuette	James and Lisa Stark	Nancy Unger	Denise Widup
Charles and	Charles Stats	Ellen and John Urness	James and Lorna Will
Bonnie Schuknecht	Kathryn A. Steckelberg	Patricia Ustine	Brian Williams
Earl Schultz	Joanne Steiner	Lynne and Keith Valiquette	Jeanette Williams
Marilyn Schultz	Michael and Therese Stevens	Carol and Richard Van Boxel	Hampton Wilmot
David and Dorothy Schulz	Cheryl Stolte	Maureen C. Van Dinter	David and Ann Wilson
Frederic and Janice Schulz	Robert Stone	Mary Van Gorden	Alfred Wojta
Carol Schwanz	Mary Stott and John Becker	Diane Veith	Betty Wolf
Dennis and Karen Schwedersky	Carol Stotts	Gerald D. Viste	Harriet Wolk
John and Susan Scripp	Petra Streiff and	Ruth Voss	Diana Wood
Ronald and Judy Seekins	Laren Stuessy	Diane and Gerald Wachdorf	Mark Wyman
The Honorable	Alan Strohschein	Daniel and Cathy Wagner	Richard J. Ziemann Fund
F. J. Sensenbrenner, Jr.	Randall and Loretta Stutzman	Ann and Michael Waidelich	of the Eau Claire
Paul and Grace Sexton	Robert and Cindy Swartz	Gordon Waller	Community Foundation
Gary and Jane Seymour	Theresa and	Edward Wallschlaeger	Frank and Diane Zillner
Alexander Shashko	Marshall Taniguchi	Lorette Wambach	
Kathryn Shebiel	John Thiel	Walter Wartolec	
Michael and Janice Shucha	Thomas Thomas	John Washbush	
Robert Sideman	Bob and Pat Thomasgard	Nadine and Michael Waszak	



We moved from North Carolina during Covid to be close to family. We recently set up a fund to support groups like the Society. Prior to retirement, my husband and I had busy lives with careers in engineering and accounting. We are now happy to have time to pursue our interests in history. We enjoy reading the Wisconsin Magazine of History and hope to visit some of the historic sites.

Diane and Kenneth Heisig, Fitchburg, Wisconsin Historical Society Heritage Circle members

ROBERT B.L. MURPHY LEGACY CIRCLE

Members of the Murphy Legacy Circle are generous supporters who have included the Wisconsin Historical Foundation in their estate plan. We gratefully honor and celebrate their commitment to sustaining the work of the Wisconsin Historical Society for generations to come.

HOW TO MAKE A PLANNED GIFT

The Wisconsin Historical Foundation accepts a variety of planned gifts for the benefit of the Society, including through a will or trust, stocks or other securities, real estate, an IRA or other retirement assets and life insurance.

These gifts may offer you tax benefits and financial flexibility while also supporting the future of Wisconsin history. Talk with your attorney or financial advisor for advice on how to make planned giving a rewarding and meaningful part of your overall charitable giving.

FOR MORE INFORMATION, CONTACT:

Joe Kollar
Development & Planned Giving Officer
(608) 264-6585
joseph.kollar@wisconsinhistory.org

The legal name for a bequest or beneficiary designation is:
Wisconsin Historical Foundation, Inc.
(Tax ID number: 39-0921093)



Leave a legacy.
Preserve the past.
Inspire the future.

SAVE THE DATE: 2025 MLC LUNCHEONS

MAY 13, MADISON

Nakoma Golf Club

MAY 15, MILWAUKEE

The Wisconsin Club Country Club

Thank you to Murphy Desmond S.C. for its support of our annual spring luncheons for members of the Robert B.L. Murphy Legacy Circle, named after the law firm's late founder. Murphy was a founding director of the Wisconsin Historical Foundation in 1954 and served more than 40 years on the Society's Board of Curators. He passed away in 2001 and generously included the Society in his estate.

Anonymous (21)
Michael Addy and
Nancy Johnson
George R. Affeldt, Jr.
Peggy Ahlgren
Dick Ammann and Sharon
Kelley
Rima and Michael Apple
David H. and
Nancy K. Aronson
Vaunce Anne Ashby

Babcock Revocable
Intervivos Trust
Bernard and Betty Backus
Mr. and Mrs. William R. Bahr
Margaret B. Barker
Thomas and Jill Barland
Angela and Jeff Bartell
Nancy Marshall Bauer
James Becker and
Marie Zaczkowski
Dr. Stephen J.* and
Dr. Miriam R. Bensman

Todd I. and Betty J. Berens
Jane B. Bernhardt
Matt Blessing and
Susan Maloney
Will* and Ruth Bloedow
Patricia Anne Boge and
R. Jerome Boge*
Paula Bonner and
Ann Schaffer
Kathryn Borkowski
Ann and Dean Bowles
Stephen and Mary Brenton

Michael K. Bridgeman
Thomas L. Bruckner
Alan Bryner
Paul and Mari Jo Buhle
Andrew Burkart
Peter and Carol Carstensen
Barbara Constans and
Deb Rohde
Sharon Cook
Suzanne Covoloskie
Robert and **Susan Crane**
Mary Jean Cronon

Angela R. Davis
Ellen and Gerald DeMers
Robert C. Dohmen
Jennifer Eager Ehle
Calvin and Janis Edwards
Robert Elmer
Nancy J. Emmert
Jeanne L. Engle
John R. Evans
Barbara Fisher
James and Christine Frasier
Mark and Janet Gajewski
Mary Jane Greenewald
Barbara and Eric Greenfeldt
Joel and Jacquie Greiner
Thomas P. Hand and
Charlene D. Hand
Richard C. Haney
Carroll Heideman
Becky and Dale Heiking
Mark and Melinda Heinritz
Duane Hendrickson
Steve and Jane Holtzman
John O. Holzhueter
Gregory Huber
Susie Fritz Jablonic
Dr. Gretchen Jaeger
Susan C. Jensen
Faith Johnson
Steve and Lynn Karges

Joan B. Key
Tim Kiefer
Gary and Kim Kilishek
Ann L. Koski
Mary Krall
Mary Beth Kuester
David* and Helen Laird
Robert T. and Mary Jane Lake
Mark and Ilene* Laufman
Nancy Leach
David R. and Darlene A. Lee
Richard and Joan* Leffler
Stuart D. Levitan
Glen and Barbara Link
Linda L. Marcinowski
Regina Millner
Peter J. and Lisa A. Moris
Katie Mullen
Tess Mulrooney
Ruth E. Munz and
Tom H. Kalinke
Gerald Murray
Judy Nagel
Margaret Ann Olson
John R. and
Catherine C. Orton
Celene Frey and Roy Ostenso
Lyn and John* Otterstein
Bob and Holly Ottum

Maura and
Christian Øverland
Allan and Patty Patek
John D. Peters
Rick and Marge Pifer
Patricia J. Popple
Gregory Postles
James S. Reeve and
Ann Wartinbee Reeve
Richard A. and
Antoinette M.* Reinhart
Bob Rettammel
Theresa H. Richards
Fred and Nancy Risser
Elizabeth Roman
Brian and Karen Rude
Richard A.* and
Deborah L. Schlitz
Michael* and
Linda Schmudlach
Don and Cindy Schott
Robert Schubert
Peter and Diane Schumacher
Margaret Schweda
Lisa and Jeffrey Sek
Stephen* and Monica Sentoff
Donna J. Sereda
Janet Seymour
Judith Siers-Poisson and
Jean-Marc Poisson

Leonard Sobczak and
David Pionke
Robert* and Delores Spitzer
Kathryn A. Steckelberg
Robert Stone
Dawn Stucki
Donald E. Swinton
Don and Judy* Taylor
John and **Carol Toussaint**
John and Willeen Tretheway
Michael and Monica Turner
Katie and Fred Valfer
Jane and David* **Villa**
George L. Vogt
Gerald Webber
Suzanne Weisman
Laurie A. Wermter
Charles E. and Ruth Werth
Alfred and Karen Weston
Carlyle H. Whipple
Richard Searer and
Cathi E. Wiebrecht-Searer
David Wilder
Keene T. and Cathy J. **Winters**
Gary Wischer
JoAnn and **Michael Youngman**
Susan M. Zaeske

**In Memoriam*

Names listed in bold denote members of the WHS Board of Curators, WHF Board of Directors, or Wisconsin Historical Real Estate Foundation Board

I feel it's important to support the Society because I have enjoyed all of its offerings for many decades and wish that others may, too, for generations to come. It makes me feel good to support the Society and I strongly believe it can keep programs and membership affordable.

Robert Schubert, Madison, Robert B.L. Murphy Legacy Circle member





**Wisconsin Historical
FOUNDATION**

**816 STATE STREET
MADISON, WI 53706**

When our three children were little, we took them on many field trips to visit Society historic sites, including Old World Wisconsin. I love the Wisconsin Magazine of History and I save many copies of the magazine and refer back to them. I also value the reciprocal museum benefit you offer to members.

Pat Safavi, Wauwatosa,
Wisconsin Historical Society member



WISCONSINHISTORY.ORG

(608) 261-1856